

Sept
2021

WESLOCK®

Security | Safety | Style | Since 1932

Price Book

No. 18

CORPORATE COMMUNICATIONS

800-575-BOLT (2658)
www.weslock.com

Accounting Department

accounting@weslock.com
Accounts Receivable / Accounts Payable

Customer Service Department

918-294-3869 fax
orders@weslock.com
Purchase Order Submission / Purchase Order Status

Warranty Department

warranty@weslock.com
Dealer & Homeowner Product Inquiries

Sales Department

sales@weslock.com
Sample Requests / Credit Applications / Sales Representative Inquiries

Marketing Department

marketing@weslock.com
Marketing Materials / Advertising

GENERAL INFORMATION

TERMS AND CONDITIONS OF SALE	2-3
HAND OF DOOR / HOW TO READ A LOCK ORDER	4
HOW TO WRITE A LOCK ORDER	5
KEYING INFORMATION	6
HOW TO REMOVE A WESLOCK® CYLINDER	7
KEYING CHARGES / PRODUCT FINISH CODES	7

MOLTEN BRONZE COLLECTION

PRODUCT DESCRIPTION CODES	2
ENTRY HANDLES & SPECIFICATIONS	3-5
KNOBS & SPECIFICATIONS	6
LEVERS & SPECIFICATIONS	7
DEADBOLTS & SPECIFICATIONS	8

ELEGANCE COLLECTION

PRODUCT DESCRIPTION CODES	2
ENTRY HANDLES & SPECIFICATIONS	3-5
KNOBS & SPECIFICATIONS	6
LEVERS & SPECIFICATIONS	7
DEADBOLTS & SPECIFICATIONS	8

TRADITIONALE COLLECTION

PRODUCT DESCRIPTION CODES	2
ENTRY HANDLES & SPECIFICATIONS	3-4
KNOBS & SPECIFICATIONS	5
LEVERS & SPECIFICATIONS	6
DEADBOLTS & SPECIFICATIONS	7

INTERCONNECT COLLECTION

PRODUCT DESCRIPTION CODES	2
1400 SERIES ENTRY HANDLES & SPECIFICATIONS	3
1500 SERIES UNIGUARD & SPECIFICATIONS	4

PREMIERE ESSENTIALS® COLLECTION

PRODUCT DESCRIPTION CODES	2
ENTRY HANDLES & SPECIFICATIONS	3-4
KNOBS & SPECIFICATIONS	5
LEVERS & SPECIFICATIONS	6
DEADBOLTS & SPECIFICATIONS	7
KNOB/DEADBOLT COMBOS	8
LEVER/DEADBOLT COMBOS	8

TRANSITIONAL COLLECTION

PRODUCT DESCRIPTION CODES	2
ENTRY HANDLES & SPECIFICATIONS	3-5
KNOBS & SPECIFICATIONS	6
LEVERS & SPECIFICATIONS	7
DEADBOLTS & SPECIFICATIONS	8

MULTI-FAMILY COLLECTION

PRODUCT DESCRIPTION CODES	2
PREMIERE ESSENTIALS LEVER & SPECIFICATIONS	3
PREMIERE ESSENTIALS DEADBOLTS & SPECIFICATIONS	3
TRANSITIONAL KNOBS & SPECIFICATIONS	4
TRANSITIONAL LEVERS & SPECIFICATIONS	4
TRANSITIONAL DEADBOLTS & SPECIFICATIONS	4

BATH COLLECTION

HOW TO READ / WRITE ORDER	2
PRODUCT DESCRIPTION CODES	3
BATH HARDWARE & SPECIFICATIONS	4-5

MISCELLANEOUS

BUILDERS HARDWARE	
HOW TO READ / WRITE A HINGE ORDER	2
HINGE BOX PRICING	2
SLIDING POCKET DOOR LOCKS	3
PARTS & ACCESSORIES	
REPLACEMENT CYLINDERS	4
INSTALLATION TOOLS	4
KEYING KITS	5
EXTRA THICK & THIN DOOR KITS	5
LATCHES & STRIKES	
STRIKES & FACEPLATES	6
LATCHES	7-8
MERCHANDISING AIDS	
LITERATURE	9
DISPLAY MOUNTS / BOARDS	9-10

The Terms and Conditions of Sale contained herein shall apply to all orders submitted for the purchase of our products and all quotations for the sale of our products. We reserve the right to refuse to accept any orders which may be submitted to us. Our acceptance of your order is expressly made conditional upon your assent to these Terms and Conditions of Sale. Your acceptance of shipment of any of the products which are ordered or your failure to specifically object to us in writing of those Terms and Conditions of Sale within five (5) days after our mailing of order acknowledgment to you shall constitute your assent to these Terms and Conditions of Sale as the entire agreement between Customer and the Company and shall cancel and supersede all previous communications, understandings, representations and agreements oral or written.

1. PRICES

- A. All prices are in U.S. \$ and are subject to change without notice and are not guaranteed. All orders will be shipped at prices in effect at time of order entry.
- B. Prices stated do not include any applicable sale, use or excise tax or any other tax, duty or charge which is now in effect or may be hereafter imposed by any Federal, State or other authority. All applicable taxes, duties or other charges shall be paid by customer in addition to price quoted or invoiced.

2. FREIGHT

- A. Delivery of the goods shall be FOB the Company's shipping point. Customer assumes all risks of loss or damage to goods following delivery to carrier at Company's point of shipment and shall provide transit insurance in amounts not, less than the full invoice price of the goods to be delivered with the Company named as loss payee or additional insured.
- B. The Company will be responsible for the payment of freight charges on all shipments of \$1,250 net or more by the carrier of the Company's selection to all points in the continental United States. Freight charges will not be paid for by the Company for shipments of less than \$1,250 net.

3. TERMS

Terms are net 30 days from date of invoice, with approved credit for domestic orders. All international sales orders must be paid with an irrevocable letter of credit, confirmed by a United States Bank payable at sight, valid for a least 75 days or prepaid before shipment.

4. ORDERS AND ACKNOWLEDGMENTS

- A. No order will be binding on the Company unless or until it has been accepted and acknowledged in writing by an authorized representative of the Company.
- B. Orders and all shipments thereunder are subject to approval by the Company.
- C. All sales are final.

5. ORDER CHANGES

Changes to any custom order after it has been released for production are subject to a charge to be determined by the Company but to be not less than \$25.00 net. All changes to any order must be in writing and accepted in writing by the Company. Additions to any in-house order must be handled as a separate order and must meet applicable minimum order requirements.

6. MINIMUM CHARGES

Due to the expense involved in the entering, handling and charging for orders less than \$200.00 net invoice, a fee of \$25.00 will be added, and the minimum order size for locks must be ordered in full case quantities.

7. SHIPMENTS

- A. Upon delivery of shipments to the carrier at the Company's facility, title to, and the risk of loss or damage in transit for such shipments, passes to our customer.
- B. Orders will be filled to the extent of our stock on hand and any balance forwarded as soon as possible.
- C. Ship dates on acknowledgments are estimates only which cannot be guaranteed because of the possibility of circumstances and conditions beyond our reasonable control. Under no circumstances shall we be responsible for any inability or delay in meeting shipping schedules or for any loss or damage (whether direct or consequential) resulting therefrom.
- D. Orders returned due to incorrect ship to address will be assessed a \$10 Handling Fee per box, plus freight charges for re-shipment.

8. PRICE CLAIMS

Claims on prices must be submitted within thirty days from date of invoice.

9. ERRORS IN SHIPMENT

Buyer is responsible for inspecting shipments and notifying Company within ten (10) days of any shortages, defects or other problems in delivery. No goods are to be returned to the Company without prior written approval. Credit or replacement will only be made after a thorough inspection of the products has been made by our representatives and investigation shows an error in shipment. A factory return authorization will be provided by our sales representative for returnable merchandise and must accompany the shipment.

10. RETURNS

No goods are to be returned to the Company without prior written approval. A factory return good authorization (RGA) must accompany the returned shipment. Credit or replacement will only be made after a thorough inspection has been made to confirm quantity and disposition of product. There will be a 25% product restocking fee on all returned merchandise.

11. CANCELLATIONS

Cancellations of orders or any portion thereof will be allowed only upon our prior written consent and the payment of such cancellation charges as we may determine. Cancellations accepted on goods which are not regular stock; in the process of manufacture; or ready for shipment will be subject to a substantial cancellation charge.

12. MATERIAL AND FINISHES

- A. Specifications, weights, dimensions and descriptions are actual or careful estimates but are not guaranteed and are subject to variations or change without notice.
- B. We reserve the right to furnish materially equivalent substitutes for material which cannot be obtained in sufficient quantities due to existing shortages or other factors outside the Company's control.
- C. Although we apply the finest protective coating available to the plated surface of our products (Brass, and other Antique Finishes), they have their limitations and in time the protective coating may deteriorate from exposure to weather, perspiration, frequency of use or other factors. Tarnishing or excessive wear of these finishes is therefore, not a defect, but a normal process which is unavoidable. Under these circumstances, finishes cannot be guaranteed and, therefore, products will not be repaired or replaced under our limited warranty for deterioration, tarnishing or wear of finishes.

13. LIMITED WARRANTY

Warranties cover the original residential user of Weslock® Products against defects in material and workmanship as long as the original user occupies the residential premises upon which the product was originally installed. This warranty DOES NOT COVER abused or misused products or if a Weslock® Product is used in commercial applications. Upon return of a defective Product to Weslock®, Weslock® shall either repair or replace the Product. Weslock® is not responsible for the cost to install the product or any defects caused by incorrect installation.

IF YOU HAVE A COVERED DEFECT, CALL OR FAX CUSTOMER SERVICE:

Phone: (800) 575-2658 Fax: (918) 294-3869

Please allow 4 to 6 weeks for warranty work or refund.

A finish deterioration occurring from the use of paints, solvents, or other chemicals is not a defect in the finish and is not covered by this warranty. Weslock® is not liable for incidental or consequential damages. Some states do not allow the exclusion or limitations of incidental or consequential damages, so the above exclusion may not apply to you. This warranty gives you specific legal rights and you may also have other rights that vary from state to state.

Prior to November 1998 all Weslock® Products carried a Full 1 Year Warranty.

FOLLOWING WARRANTIES WERE IN EFFECT NOV. 1998 - DEC. 31, 2001

Limited Lifetime Mechanical <u>1 Year Finish</u>	10 Year Mechanical <u>1 Year Finish</u>
600 Series Knobs and Levers Levers	400 Series Knobs and Levers
2100, 1300, Plus, 1400, 1600, 1800, 680, 670 Deadbolts products	370 Series Deadbolts 1500, U.L. Rated

PREMIUM WARRANTIES WERE IN EFFECT JUNE 1999 - DEC. 31, 2001

Lifetime Finish PVD coating <u>Limited Lifetime Mechanical</u>	Optional Lifetime Finish when <u>ordered from factory with PVD</u>
Series: 6600, 6800 Exterior side 2100 Series Exterior side	Series: (640, 371, 671) Exterior side

FOLLOWING WARRANTIES WERE IN EFFECT JAN. 1, 2002 - JAN. 31, 2005

Limited Lifetime Mechanical <u>Limited Lifetime Finish</u>	Limited Lifetime Mechanical <u>10 Year Finish</u>
700 Series Knobs & Levers	400 Series Knobs & Levers*
600 Series Knobs & Levers	300 Series Deadbolts*
2100 Series Entry Handles	300, 1500 Entry Handles*
600 Series Deadbolts Molten Bronze	

* PVD Product is Limited Lifetime Finish

For warranties in effect subsequent to December 31, 2005 please see individual collections' stated warranties.

THESE WARRANTIES ARE EXPRESSLY IN LIEU OF ALL OTHER EXPRESS WARRANTIES. IMPLIED WARRANTIES SHALL BE LIMITED TO THE DURATION OF THE WARRANTY PERIOD OF THESE EXPRESS WARRANTIES. WESLOCK® SHALL UNDER NO CIRCUMSTANCES BE LIABLE FOR INCIDENTAL OR CONSEQUENTIAL DAMAGES OR FOR REPAIRS BY THIRD PARTIES. SOME STATES DO NOT ALLOW LIMITATIONS ON HOW LONG AN IMPLIED WARRANTY LASTS OR THE EXCLUSION OR LIMITATIONS OF INCIDENTAL OR CONSEQUENTIAL DAMAGES SO THE ABOVE LIMITATIONS OR EXCLUSION MAY NOT APPLY.

THESE WARRANTIES GIVE YOU SPECIAL RIGHTS, AND YOU MAY ALSO HAVE OTHER LEGAL RIGHTS WHICH VARY FROM STATE .

14. PATENT INDEMNITY

The sale of products by the Company does not convey any license, by implication, estoppel or otherwise, under patents covering the products alone or in combination with other devices or elements, in the event that any legal proceeding is brought against Customer claiming that the goods infringe a United States patent of a third party, the Company may agree to defend at its own expense that portion of such legal proceeding which relates to such claim and to pay any damages or costs awarded by a court on such claim against Customer, provided:

- Customer gives the Company prompt written notice of any such claim and the institution of such proceeding;
- Customer gives the Company all necessary authority, information, cooperation, and reasonable assistance to enable the Company, at its option, to compromise, settle or defend such legal proceeding;
- Customer shall not, without prior written consent of the Company, compromise any such claim or deal with the claimant in any manner with respect to such claim.

THE COMPANY SHALL HAVE NO LIABILITY TO INDEMNIFY CUSTOMER FOR ANY INFRINGEMENT ARISING FROM:

- The combination of the goods with any other product, part, device or element not furnished by the Company to Customer if the infringement would not have occurred from the use of the goods alone;
- A modification of the goods made at the request of Customer; or
- The furnishing to Customer of any information, date, assistance, maintenance or operation handbooks supplied with the goods.

THE COMPANY SHALL NOT BE LIABLE FOR ANY COSTS OR EXPENSES INCURRED WITHOUT THE COMPANY'S WRITTEN AUTHORIZATION.

THE FOREGOING IS STATED IN LIEU OF ANY OTHER EXPRESS, IMPLIED OR STATUTORY WARRANTIES WITH RESPECT TO ANY ALLEGED PATENT INFRINGEMENT AND SHALL BE THE SOLE AND EXCLUSIVE REMEDY OF CUSTOMER FOR PATENT INFRINGEMENT OF ANY KIND.

15. DEFAULT

If Customer is in default under any order or contract with the Company or any of our affiliated divisions or companies, or if at any time the Company shall not be satisfied with Customer's financial condition or responsibility, the Company shall have the right, without prejudice to any other legal remedy, to suspend further deliveries until such default or condition is remedied.

16. ASSIGNMENT

Customer shall not assign its orders nor any of its rights or obligations thereunder without the prior written consent of the Company.

17. APPLICABLE LAW

These Terms and Conditions of Sale and any transaction pursuant hereto between the Company and Customer shall be construed in accordance with the laws of the State of Oklahoma.

18. WAIVER AND MODIFICATION

No waiver or modification of any of these Terms and Conditions of sale shall be effective unless such waive or modification is in writing and signed by an authorized representative of the Company.

19. SEVERABILITY

If any of these Terms and Conditions of Sale are declared to be void or unenforceable for any reason, the remaining Terms and Conditions of Sale shall be unaffected and remain valid for all purposes.

20. BROKEN CASE CHARGE

There will be a 10% upcharge for all order quantities of less than full case, except for crossfunction keyed products.

21. INCOMPLETE LOCKSETS

Locksets ordered less component parts are billed at full price (Does not apply to bulk pack product)

22. MINIMUM ANNUAL SALES VOLUME REQUIREMENTS

The Company reserves the right to discontinue direct sales to any Customer who does not meet the minimum annual sales volume requirements during each Calendar Year. That requirement currently is \$30,000. The minimum annual sales volume requirement is determined on the basis of accepted, non-canceled customer orders during each applicable Calendar Year. This requirement is necessary because our bookkeeping, catalog, and sales support and service costs to keep accounts open in most cases may run over any significant profit which might be realized on any sales volume below this level. The Company reserves the right to change any or all minimum annual sale volume requirements from time to time. It is also agreed and understood that the attainment of the minimum annual sales volume requirement is but one of the Company's requirements to continue as a direct customer of the Company and that we may terminate direct sales to any Customer in accordance with any agreements between the Company and the Customer or for failure to meet the Company's requirements as determined by the Company in its sole judgment.

23. MISCELLANEOUS

- Orders not specified with keying requirements in Molten Bronze, Elegance and Traditionale Collection will be shipped Keyed Differently (KD) for entry handles and shipped Keyed Alike (3) for all other products.
- Orders not specified with keying requirements in Premiere Essentials and Transitional Collections will be shipped Keyed Differently (KD) for entry handles and shipped Keyed Alike (2) for all other products.
- WESLOCK® reserves the right to revise or modify products, product information or pricing without notice.
- Product specifications and prices reflect available information at the printing of this price list.
- WESLOCK® is not responsible for typographical or printing errors.

24. BACK CHARGES

We are not responsible for unauthorized back charges and will not accept any charges for labor or material incurred by anyone other than Weslock® for any installation repair, service or replacement unless prior written approval has been given.

HOW TO DETERMINE HAND OF DOOR

LEFT HAND DOOR

1. Stand outside room.
2. Face Door.
3. Hinges on left side.

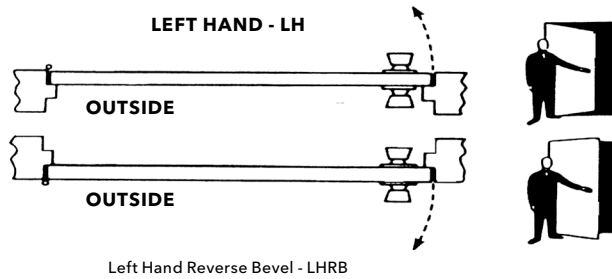

RIGHT HAND DOOR

1. Stand outside room.
2. Face Door.
3. Hinges on right side.

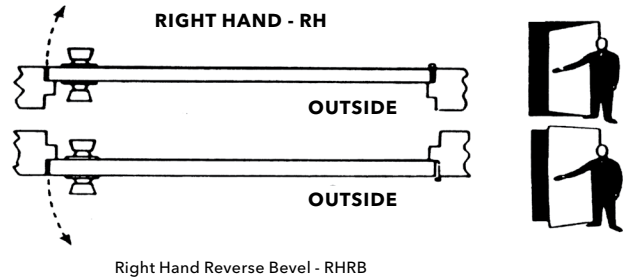

Weslock's® computer program requires assigning a unique 13 digit part number to each specific item being ordered. Each of the 13 digit positions describes the specific attributes of the product. The information provided by each digit's position is illustrated as follows:

HOW TO READ A LOCK ORDER

(How to read a 13 digit part number.)

POSITION	1	2	3	4	5	6	7	8	9	10	11	12	13
	R or L For Indicating Handing When Required, Otherwise Place a 0	Model Number			Outside Knob / Lever Style	Outside Finish	Inside Knob / Lever Style	Inside Finish		Latch / Strike Code		Pack Code	Key Code

HOW TO WRITE A LOCK ORDER

(The following ordering example shows the 13 digit product code as it will appear on all acknowledgments.)

POSITION	1	2-5	6	7	8	9	10-11	12	13
QUANTITY	HANDING	MODEL #	EXT. KNOB STYLE	EXT. FINISH	INT. KNOB STYLE	INT. FINISH	LATCH/STRIKE CODE	PACK CODE*	KEYING CODE
ENTRY HANDLE									
Example: 2810 Series Entry Handle in Satin Nickel with Interior Hudson Knob, Keyed Different									
4	O	2810	-	N	G	N	FR	2	D
DEADBOLT									
Example: Builder Box 300 Series Double Cylinder Deadbolt in Antique Brass, Keyed Different and Master Keyed									
30	O	0372	-	A	-	A	SL	2	KD/MK
KEYLOCK									
Example: Builder Box Impresa Keylock in Oil-Rubbed Bronze with Drive-in Latches, Keyed Alike in sets of 3									
30	O	0640	I	1	I	1	DI	2	KA3
Example: Builder Box Right Handed Bordeáu Keylock in Black with adjustable latch. Keyed Alike in sets of 2									
12	R	0640	U	2	U	2	SL	2	KA2
PASSAGE/PRIVACY									
Example: Builder Box Bordeáu Passage Lever in Brass									
12	O	0600	U	3	U	3	SL	2	O
Example: Builder Box Julienne Privacy in Satin Nickel									
30	O	0610	J	N	J	N	SL	2	O
DUMMY									
Example: Builder Box Impresa Dummy Knob in Bright Chrome									
30	O	0605	I	6	-	-	OO	2	O
Example: Builder Box Impresa Dummy Passage Set in Satin Chrome									
30	O	0606	I	D	I	D	OO	2	O

*NOTE: Builder Box Pack Code "2", Retail/Visual Pack Code "X".

HOW TO WRITE A LIP LOCK ORDER

(The following ordering example shows the 13 digit product code as it will appear on all acknowledgments.)

POSITION	1	2-5	6	7	8	9	10-11	12	13
QUANTITY	HANDING	MODEL #	EXT. KNOB	EXT. FINISH	INT. KNOB STYLE	INT. FINISH	LATCH/STRIKE CODE	PACK CODE*	KEYING CODE
ENTRY HANDLE									
Example: Builder Box Castletown entry handle in Oil-Rubbed Bronze with Interior Wexford Knob, Keyed Different									
2	O	7625	-	1	-	-	OO	2	D
2	O	7400	-	-	F	1	SL	2	O
Example: Builder Box Belmont entry handle in Satin Nickel with Interior Impresa Knob or Urbana Lever, Keyed Different									
2	O	6691	-	N	-	-	OO	2	D
1	O	6200	-	-	I	N	SL	2	O
1	O	6200	-	-	2	N	DI	2	O
Example: Builder Box Lexington 2100 Series entry handle in Satin Nickel with Interior LH Bordeáu Lever, Double Cylinder, Keyed Different									
1	O	2115	-	N	-	-	OO	2	D
1	L	2109	-	-	U	N	SL	2	D

*NOTE: Builder Box Pack Code "2", Retail/Visual Pack Code "X".

KEYING TERMS

KD	Keyed Different
KA	Keyed Alike
KA2	Keyed Alike (2 Locks)
KA3	Keyed Alike (3 Locks)
KA6	Keyed Alike (6 Locks)
MK	Master Keyed
GM	Grand Master Keyed
KTP	Keyed to Pass
OG	Owner-Guard (construction keying)
BK	Owner-Guard (Master Key System)
HG	Home-Guard (construction keying)
KO	Knockout Key

TYPES OF KEYING

STANDARD KEYING

All locksets, deadbolts and entry handles come with 2 keys per lockset and will be keyed alike in any quantity. Specify KA2 (2 locks alike) - KA5 (5 locks alike)

EXAMPLE: 640 IMP AB X AB KA5 (five (5) locks would be keyed alike)

MASTER KEYING

Frequently it becomes necessary to provide a group of locks, each having a different and non-interchangeable key, but all having in common one master key capable of operating each of the locks in the group. This arrangement is most often used in rental units such as apartment or office buildings.

EXAMPLE: 640 IMP AB X AB KD MK (all locks would be keyed differently - all operable by one master key)

Often, single family housing tracts require groups of locks keyed alike, but having only one (such as the front door lock) master keyed.

EXAMPLE: 640 IMP AB X AB KA3 1MK (three (3) locks would be keyed alike - only one operable by master key)

GRAND MASTER KEYING

On occasion, it becomes necessary to provide more than one group of locks each having a different and non-interchangeable key, each group having in common one master key capable of operating each of the locks in the group plus a grand master key capable of operating every lock in each group.

EXAMPLE: 640 IMP AB X AB KA3 3MK 3GM (three (3) locks would be keyed alike - three (3) locks would be master keyed to be operable by the group and grand master keys)

EXAMPLE: 640 IMP AB X AB KA3 1MK 1GM (three (3) locks would be keyed alike - only one of the three would be master keyed to be operable by the group and grand master keys)

HOME-GUARD™ KEYING

SEE ILLUSTRATION (this page)

EXAMPLE: 640 IMP AB X AB KA3 3MK 3HG (three (3) locks would be keyed alike - three (3) locks would be operable by the builder master key until disabled by the tenant or owner key)

OWNER-GUARD™ KEYING

SEE ILLUSTRATION (this page)

EXAMPLE: 640 IMP AB X AB KA3 3MK 3OG (three (3) locks would be keyed alike - all locks would be operable by the builder master key until disabled by the knock-out key - master key continues to operate all locks after builder master has been disabled)

KEYED TO PASS KEYING

This type of keying is usually used in keylocks for doors which are common to a particular building or complex, i.e. utility rooms, recreation rooms, laundry rooms, swimming pool gates, in which all different and non-interchangeable tenant keys must operate the keyed to pass lock.

EXAMPLE: 640 IMP AB X AB MK KTP (this lock would be keyed such that every tenant key and the master would operate this common lock)

HOME-GUARD™

The Home-Guard (HG) version normally uses two (2) keys, a BUILDER KEY, for use during construction and a TENANT OR OWNER KEY which automatically disables (knocks out) the builder key the first time it is used. For maximum control of the tenant key, it is supplied in a sealed envelope since the builder key is used during installation.

This version is not normally master-keyed, but may be if desired.

HERE'S HOW THE HOME-GUARD WORKS:

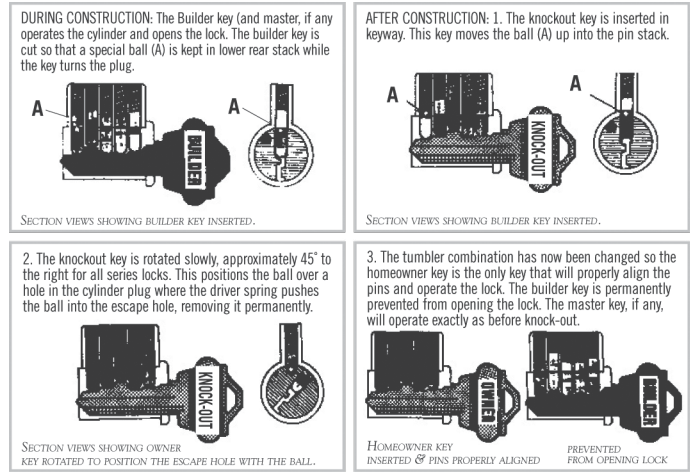

OWNER-GUARD™

The Owner-Guard (OG) version normally uses four (4) keys, a BUILDER KEY, for use during construction, a MASTER KEY, which works during, as well as after construction, a TENANT KEY, which does not disable the builder key, and a separate KNOCKOUT KEY, that does disable the builder key and will not work thereafter.

A special feature of the new construction-key system is that a customer can inter-mix the two versions (HG & OG) since they can be keyed to use the same builder key (and same master key, if desired).

HERE'S HOW THE OWNER-GUARD WORKS:

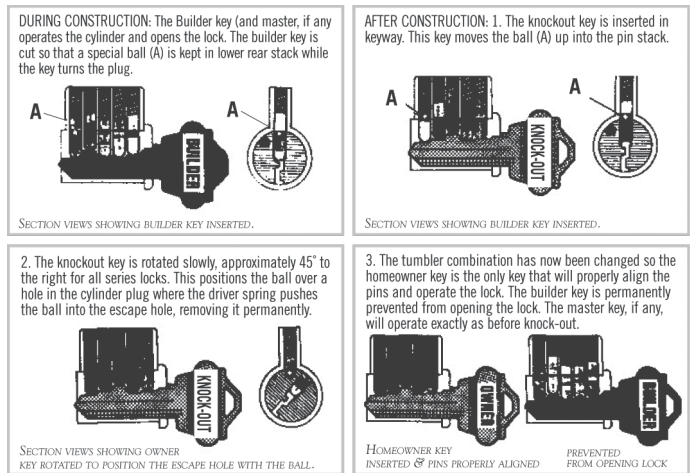

WHEN ORDERING HOME-GUARD AND OWNER-GUARD LOCKS FOR PRE-EXISTING OR ON-GOING SYSTEMS, YOU ARE REQUIRED TO ORDER HG, OG AND KO KEYS SEPARATELY.

HOW TO REMOVE A WESLOCK® CYLINDER AND CHANGE THE HAND OF DOOR

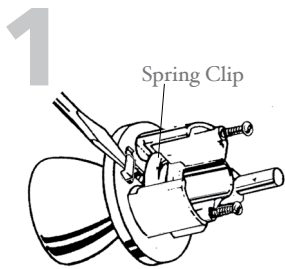

1
To remove outside knob/lever, remove spring clip with screwdriver (if necessary).

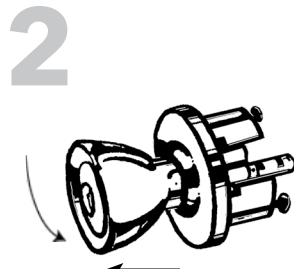

2
Turn knob to the extreme left and remove.

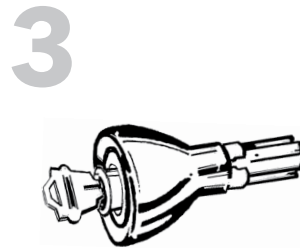

3
Insert and turn key 180°, withdraw cylinder, turn key 180° again, and withdraw key.

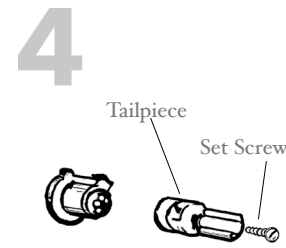

4
Remove screw and tailpiece.

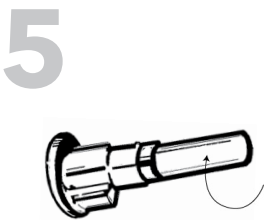

5
Turn tailpiece 180° and re-insert. Adjust screw tension to insure free rotation of plug.

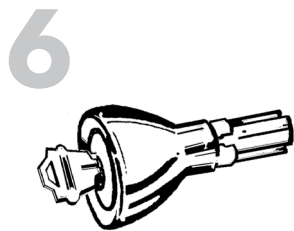

6
Insert key, turn 180°. Put cylinder in knob, tailpiece OPPOSITE the spindle. Turn key 180° and withdraw.

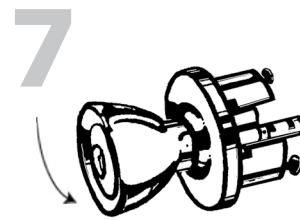

7
Insert knob with cylinder into housing. Turn to the extreme left and PUSH until knob is seated and rotates in normal position. Push button, locking assembly.

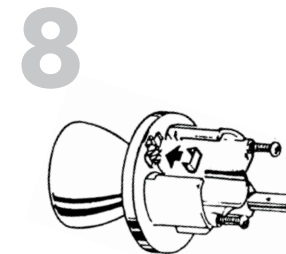

8
Reinsert spring clip if necessary. Lock is now ready for installation.

* Does not apply to the Premiere Essentials® or Transitional collections of Products

KEYING CHARGES

DESCRIPTION	KEYING CODES	LIST PRICE
Keyed Alike	A	Included
Keyed Different	D	Included
Master Keying charge per lock	M	\$5.50
Grand Master Keying charge per lock	G	\$7.50
Keying to Pass charge per lock	KTP	\$8.60
Home Guard charge per lock	HG	\$6.00
Owner Guard charge per lock (includes Master Key)	BK	\$6.50
Owner Guard charge per lock	OG	\$6.00

The above keying charges are added to the list price(s) of Keyed Lockset(s) when the corresponding special keying is requested.

PRODUCT FINISH CODES

FINISHES	U.S.	BMA	WESLOCK
Polished Brass	3	605	3
Lifetime Polished Brass (PVD)	L03	605E	B
Antique Brass	5	609	A
Bright Chrome	26	625	6
Satin Chrome	26D	626	D
Satin Nickel	15	619	N
Oil Rubbed Bronze	10B	613	1
Black	19	622	2





GENERAL INFORMATION

PRODUCT DESCRIPTION CODES 2

COLLECTION PRICING & SPECIFICATIONS

ENTRY HANDLES 3-5

KNOBS 6

LEVERS 7

DEADBOLTS 8

Limited Lifetime Mechanical Warranty • Limited Ten Year Finish Warranty

[THE FOLLOWING TABLES DESCRIBE SPECIFIC PRODUCT DESCRIPTION
CODES THAT ARE UNIQUE TO EACH POSITION IN THE SYSTEM.]

HANDING POSITION 1

Position 1 is used for indicating right (R) or left (L) handing of levers and handlesets when applicable. Use a zero (0) when handing is not required.

MODEL NUMBERS POSITIONS 2,3,4,5

Positions 2, 3, 4 & 5 are used to indicate the model and function of knobs, levers, deadbolts and handlesets. For those products with only three (3) digit model numbers, place a zero (0) in position 2.

- Knobsets / Leversets: See model numbers on pages 6 & 7
- Deadbolts: See model numbers on page 8
- Handlesets: See model numbers on pages 3, 4 & 5

EXTERIOR & INTERIOR KNOB & LEVER DESIGNS POSITIONS 6 & 8

KNOBS	CODE
Wexford	F
Durham	M
LEVERS	CODE
Carlow	H
Boulder	C

EXTERIOR & INTERIOR FINISH CODES POSITIONS 7 & 9

FINISHES	U.S.	BMA	WESLOCK
Oil Rubbed Bronze	10B	613	1
Black	19	622	2

LATCH CODES POSITIONS 10 & 11

CODE	LATCH
S L	2-3/8" or 2-3/4", Adjustable Latch Square & Radius Faceplate
D I	2-3/8" or 2-3/4", Adjustable Drive-in Latch Square & Radius Faceplates

PACKAGING CODES POSITION 12

PACKAGING TYPES	CODE
Bulk Pack	0
Box Pack w/ Phillips Head Wood Screws	2
Retail Pack	X

KEYING CODES POSITION 13

KEYING TYPES	CODE
Keyed Alike	A
Keyed Different	D
Master Keying charge per lock	M
Grand Master Keying charge per lock	G
Keying to Pass charge per lock	KTP
Home Guard charge per lock	HG
Owner Guard charge per lock (includes Master Key)	BK
Owner Guard charge per lock	OG
No Cylinder (zero)	0

LATCH & STRIKE SCREWS STANDARD

No. 7x3/4" Phillips Head Sheet Metal Screws for wood doors.



CASTLETOWN

HANDING	MODEL #	DESCRIPTION	PKG.	CASE WT	CASE QTY	1	2
-	7625	Exterior Handleset	Box	24	4	294.00	294.00
-	7615	Exterior Handleset-Dummy	Box	24	4	294.00	294.00
^R/L	7400	Interior Single Cylinder Trim	Box	13	4	118.00	118.00
^R/L	7402	Interior Double Cylinder Trim	Box	15	4	118.00	118.00
^R/L	7405	Interior Dummy Trim	Box	12	4	118.00	118.00

Available in any Molten Bronze collection knob or lever style.

^Handing required when interior trim uses a handed lever.



STONEBRIAR

HANDING	MODEL #	DESCRIPTION	PKG.	CASE WT	CASE QTY	1	2
-	7631	Exterior Handleset	Box	14	2	317.00	317.00
-	7635	Exterior Handleset-Dummy	Box	14	2	317.00	317.00
^R/L	7600	Interior Single Cylinder Trim	Box	14	4	127.00	127.00
^R/L	7602	Interior Double Cylinder Trim	Box	16	4	127.00	127.00
^R/L	7604	Interior Interconnect Trim	Box	14	4	197.00	197.00
^R/L	7605	Interior Dummy Trim	Box	13	4	127.00	127.00

Available in any Molten Bronze collection knob or lever style.

^Handing required when interior trim uses a handed lever.



WILTSHIRE

HANDING	MODEL #	DESCRIPTION	PKG.	CASE WT	CASE QTY	1	2
-	7680	Exterior Handleset	Box	17	2	349.00	349.00
-	7685	Exterior Handleset-Dummy	Box	17	2	349.00	349.00
^R/L	7600	Interior Single Cylinder Trim	Box	14	4	127.00	127.00
^R/L	7602	Interior Double Cylinder Trim	Box	16	4	127.00	127.00
^R/L	7604	Interior Interconnect Trim	Box	14	4	197.00	197.00
^R/L	7605	Interior Dummy Trim	Box	13	4	127.00	127.00

Available in any Molten Bronze collection knob or lever style.

^Handing required when interior trim uses a handed lever.

GENERAL SPECIFICATIONS

PRODUCT CATEGORY	CYLINDER		STRIKES		FACEPLATES		DOOR HANDING	ADA	ANSI	UL	BORING REQUIREMENTS				DOOR THICKNESS		BACKSET	LATCH BOLT THROW		
	STANDARD	OPTIONAL	DEADBOLT	HANDLE	STANDARD	OPTIONAL					CROSS BORE		EDGE BORE	LATCH FACE	STANDARD	SPECIAL		DEADBOLT	HANDLE	
											DEADBOLT	HANDLE								
Handlesets	5 Pin Weslock Keyway	5 Pin Schlage C or Kwikset Keyway	2-1/4" full lip and 1" x 2-1/4" no lip, Radius & Square	2-1/4" full lip, Radius & Square	1" x 2-1/4", Removable Radius & Square	Drive-in 1" x 2-1/4", Removable Radius & Square	Specify handing on all interior trims with handed levers.	N/A	A 156.2 Grade II	N/A	2-1/8" or 1-5/8"	2-1/8"	1"	1" x 2-1/4"	1-3/4" - 2"	2" - 2-1/4"	Adjustable	2-3/8" or 2-3/4"	1"	1/2"

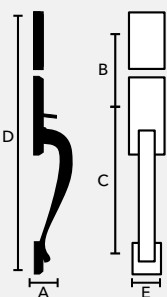

MODEL		A	B	C	D	E
Castletown	Exterior	2-3/4"	*5-1/2"	8-3/4" - 10"	18-1/2"	2-3/4"
Stonebriar	Interior	2-3/4"	5-1/2"	-	10-1/8"	2-3/4"
	Exterior	2-3/4"	5-1/2"	8-3/4" - 10"	18-1/2"	2-3/4"
Wiltshire	Interior	2-3/4"	5-1/2"	-	18-1/2"	2-3/4"
	Exterior	2-3/4"	5-1/2"	8-3/4" - 10"	19-1/4"	2-3/4"

*5-1/4" minimum

CLASSIFICATION KEY

- A - Projection from Door
- B - Center to Center
- C - Footscrew
- D - Full Length
- E - Width of Rose (Escutcheon Plate)



ASPEN

HANDING	MODEL #	DESCRIPTION	PKG.	CASE WT	CASE QTY	1	2
-	7925	Exterior Handleset	Box	25	4	294.00	294.00
-	7915	Exterior Handleset-Dummy	Box	25	4	294.00	294.00
^R/L	7800	Interior Single Cylinder Trim	Box	14	4	118.00	118.00
^R/L	7802	Interior Double Cylinder Trim	Box	16	4	118.00	118.00
^R/L	7805	Interior Dummy Trim	Box	13	4	118.00	118.00

Available in any Molten Bronze collection knob or lever style.

^Handing required when interior trim uses a handed lever.



GREYSTONE

HANDING	MODEL #	DESCRIPTION	PKG.	CASE WT	CASE QTY	1	2
-	7931	Exterior Handleset	Box	15	2	317.00	317.00
-	7935	Exterior Handleset-Dummy	Box	15	2	317.00	317.00
^R/L	7900	Interior Single Cylinder Trim	Box	15	4	127.00	127.00
^R/L	7902	Interior Double Cylinder Trim	Box	17	4	127.00	127.00
^R/L	7904	Interior Interconnect Trim	Box	15	4	197.00	197.00
^R/L	7905	Interior Dummy Trim	Box	14	4	127.00	127.00

Available in any Molten Bronze collection knob or lever style.

^Handing required when interior trim uses a handed lever.



ROCKFORD

HANDING	MODEL #	DESCRIPTION	PKG.	CASE WT	CASE QTY	1	2
-	7980	Exterior Handleset	Box	18	2	349.00	349.00
-	7985	Exterior Handleset-Dummy	Box	18	2	349.00	349.00
^R/L	7900	Interior Single Cylinder Trim	Box	15	4	127.00	127.00
^R/L	7902	Interior Double Cylinder Trim	Box	17	4	127.00	127.00
^R/L	7904	Interior Interconnect Trim	Box	15	4	197.00	197.00
^R/L	7905	Interior Dummy Trim	Box	14	4	127.00	127.00

Available in any Molten Bronze collection knob or lever style.

^Handing required when interior trim uses a handed lever.

GENERAL SPECIFICATIONS

PRODUCT CATEGORY	CYLINDER		STRIKES		FACEPLATES		DOOR HANDING	ADA	ANSI	UL	BORING REQUIREMENTS				DOOR THICKNESS		BACKSET	LATCH BOLT THROW		
	STANDARD	OPTIONAL	DEADBOLT	HANDLE	STANDARD	OPTIONAL					CROSS BORE		EDGE BORE	LATCH FACE	STANDARD	SPECIAL		DEADBOLT	HANDLE	
											DEADBOLT	HANDLE								
Handlesets	5 Pin Weslock Keyway	5 Pin Schlage C or Kwikset Keyway	2-1/4" full lip and 1" x 2-1/4" no lip, Radius & Square	2-1/4" full lip, Radius & Square	1" x 2-1/4", Removable Radius & Square	Drive-in 1" x 2-1/4", Removable Radius & Square	Specify handing on all interior trims with handed levers.	N/A	A 156.2 Grade II	N/A	2-1/8" or 1-5/8"	2-1/8"	1"	1" x 2-1/4"	1-3/4" - 2"	2" - 2-1/4"	Adjustable	2-3/8" or 2-3/4"	1"	1/2"

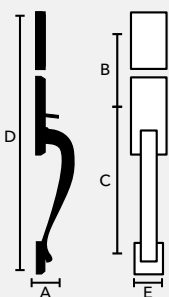

MODEL		A	B	C	D	E
Aspen	Exterior	2-3/4"	*5-1/2"	8-3/4" - 10"	18-1/2"	2-3/4"
Greystone	Interior	2-3/4"	5-1/2"	-	10-1/8"	2-3/4"
	Exterior	2-3/4"	5-1/2"	8-3/4" - 10"	18-1/2"	2-3/4"
Rockford	Interior	2-3/4"	5-1/2"	-	18-1/2"	2-3/4"
	Exterior	2-3/4"	5-1/2"	8-3/4" - 10"	19-1/4"	2-3/4"

*5-1/4" minimum

CLASSIFICATION KEY

- A - Projection from Door
- B - Center to Center
- C - Footscrew
- D - Full Length
- E - Width of Rose (Escutcheon Plate)



TRAMORE INTERIOR TRIM INCLUDED

HANDING	MODEL #	DESCRIPTION	PKG.	CASE WT	CASE QTY	1	2
^R/L	7641	Single Cylinder Deadbolt Passage	Box	23	4	292.00	292.00
^R/L	7645	Dummy Handle (all parts rigid)	Box	23	4	292.00	292.00

Available in any Molten Bronze collection knob or lever style.

^Handing required with all knob and lever styles.



BRAUGHTON INTERIOR TRIM INCLUDED

HANDING	MODEL #	DESCRIPTION	PKG.	CASE WT	CASE QTY	1	2
^R/L	7941	Single Cylinder Deadbolt Passage	Box	23	4	292.00	292.00
^R/L	7945	Dummy Handle (all parts rigid)	Box	23	4	292.00	292.00

Available in any Molten Bronze collection knob or lever style.

^Handing required with all knob and lever styles.

GENERAL SPECIFICATIONS

PRODUCT CATEGORY	CYLINDER		STRIKES		FACEPLATES		DOOR HANDING	ADA	ANSI	UL	BORING REQUIREMENTS				DOOR THICKNESS		BACKSET	LATCH BOLT THROW	
	STANDARD	OPTIONAL	DEADBOLT	HANDLE	STANDARD	OPTIONAL					CROSS BORE		EDGE BORE	LATCH FACE	STANDARD	SPECIAL		DEADBOLT	HANDLE
											DEADBOLT	HANDLE							
Handlesets	5 Pin Weslock Keyway	5 Pin Schlage C or Kwikset Keyway	2-1/4" full lip and 1" x 2-1/4" no lip, Radius & Square	2-1/4" full lip, Radius & Square	1" x 2-1/4", Removable Radius & Square	Drive-in 1" x 2-1/4", Removable Radius & Square	Specify handing on all functions.	N/A	A 156.2 Grade II	N/A	2-1/8" or 1-5/8"	2-1/8"	1"	1" x 2-1/4"	1-3/4" - 2"	2" - 2-1/4"	Adjustable 2-3/8" or 2-3/4"	1"	1/2"

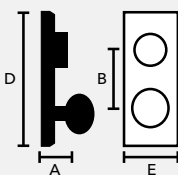

MODEL		A	B	C	D	E
Tramore	Interior	2-3/4"	5-1/2"	-	10-1/8"	2-3/4"
	Exterior	2-3/4"	5-1/2"	-	10-1/4"	2-3/4"
Braughton	Interior	2-1/2"	5-1/2"	-	10-1/8"	2-3/4"
	Exterior	2-1/2"	5-1/2"	-	10-1/4"	2-3/4"

CLASSIFICATION KEY

- A - Projection from Door
- B - Center to Center
- C - Footscrew
- D - Full Length
- E - Width of Rose (Escutcheon Plate)

WEXFORD KNOB (F)

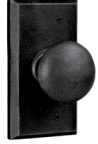

	HANDING	MODEL #	DESCRIPTION	PKG.	CASE WT	CASE QTY	1	2
PREMIERE	-	7100	Passage (Hall & Closet)	Box	44	15	150.00	150.00
	-	7105	Dummy Knob	Box	36	30	75.00	75.00
	-	7110	Privacy (Bed & Bath)	Box	46	15	150.00	150.00
	-	7140	Keylock (Keyed Entry)	Box	49	15	184.00	184.00

SQUARE	-	7300	Passage (Hall & Closet)	Box	36	15	150.00	150.00
	-	7305	Dummy Knob	Box	28	30	75.00	75.00
	-	7310	Privacy (Bed & Bath)	Box	38	15	150.00	150.00
	-	7340	Keylock (Keyed Entry)	Box	41	15	184.00	184.00

DURHAM KNOB (M)

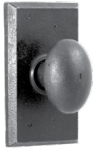

	HANDING	MODEL #	DESCRIPTION	PKG.	CASE WT	CASE QTY	1	2
PREMIERE	-	7100	Passage (Hall & Closet)	Box	44	15	150.00	150.00
	-	7105	Dummy Knob	Box	36	30	75.00	75.00
	-	7110	Privacy (Bed & Bath)	Box	46	15	150.00	150.00
	-	7140	Keylock (Keyed Entry)	Box	49	15	184.00	184.00

SQUARE	-	7300	Passage (Hall & Closet)	Box	36	15	150.00	150.00
	-	7305	Dummy Knob	Box	28	30	75.00	75.00
	-	7310	Privacy (Bed & Bath)	Box	38	15	150.00	150.00
	-	7340	Keylock (Keyed Entry)	Box	41	15	184.00	184.00

GENERAL SPECIFICATIONS

PRODUCT CATEGORY	CYLINDER		STRIKES		FACEPLATES		DOOR HANDING	ADA	ANSI	UL	BORING REQUIREMENTS			DOOR THICKNESS		BACKSET	LATCH BOLT THROW		
	STANDARD	OPTIONAL	DEADBOLT	HANDLE	STANDARD	OPTIONAL					CROSS BORE		EDGE BORE	LATCH FACE	STANDARD		SPECIAL	DEADBOLT	HANDLE
											DEADBOLT	HANDLE							
Knobs	5 Pin Weslock Keyway	5 Pin Schlage Cor Kwikset Keyway	2-1/4" full lip, Radius & Square		1" x 2-1/4", Removable Radius & Square	Drive-in 1" x 2-1/4", Removable Radius & Square	Reversible for right or left-hand doors	N/A	A 156.2 Grade II	N/A	2-1/8"	1"	1" x 2-1/4"	1-3/8" - 1-3/4"	1-3/4" - 2-1/4"	Adjustable 2-3/8" or 2-3/4"	1/2"		

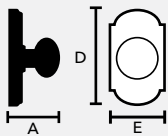

MODEL	A	B	C	D	E
Wexford Premiere	2-1/2"	-	-	5"	2-3/4"
Wexford Square	2-1/2"	-	-	5"	2-3/4"
Durham Premiere	2-1/2"	-	-	5"	2-3/4"
Durham Square	2-1/2"	-	-	5"	2-3/4"

CLASSIFICATION KEY

- A - Projection from Door
- B - Center to Center
- C - Footscrew
- D - Full Length
- E - Width of Rose (Escutcheon Plate)

BOULDER NON-HANDED LEVERSETS (C)



	HANDING	MODEL #	DESCRIPTION	PKG.	CASE WT	CASE QTY	1	2
SQUARE	-	7300	Passage (Hall & Closet)	Box	43	12	150.00	150.00
	-	7305	Dummy Lever	Box	37	30	75.00	75.00
	-	7310	Privacy (Bed & Bath)	Box	46	12	150.00	150.00

CARLOW HANDED LEVERSETS (H)

Specify Right or Left when ordering



	HANDING	MODEL #	DESCRIPTION	PKG.	CASE WT	CASE QTY	1	2
PREMIERE	R/L	7100	Passage (Hall & Closet)	Box	41	12	150.00	150.00
	R/L	7105	Dummy Lever	Box	36	30	75.00	75.00
	R/L	7110	Privacy (Bed & Bath)	Box	41	12	150.00	150.00
	R/L	7140	Keylock (Keyed Entry)	Box	43	12	184.00	184.00



SQUARE	R/L	7300	Passage (Hall & Closet)	Box	42	12	150.00	150.00
	R/L	7305	Dummy Lever	Box	37	30	75.00	75.00
	R/L	7310	Privacy (Bed & Bath)	Box	42	12	150.00	150.00
	R/L	7340	Keylock (Keyed Entry)	Box	44	12	184.00	184.00

GENERAL SPECIFICATIONS

PRODUCT CATEGORY	CYLINDER		STRIKES		FACEPLATES		DOOR HANDING	ADA	ANSI	UL	BORING REQUIREMENTS			DOOR THICKNESS		BACKSET	LATCH BOLT THROW		
	STANDARD	OPTIONAL	DEADBOLT	HANDLE	STANDARD	OPTIONAL					CROSS BORE		EDGE BORE	LATCH FACE	STANDARD		SPECIAL	DEADBOLT	HANDLE
											DEADBOLT	HANDLE							
Leverets	5 Pin Weslock Keyway	5 Pin Schlage C or Kwikset Keyway	2-1/4" full lip, Radius & Square		1" x 2-1/4", Removable Radius & Square	Drive-in 1" x 2-1/4", Removable Radius & Square	Specify handing for Carlow levers, all other styles are reversible for right or left-hand doors	All Functions Meet Sec. 4.13.9	A 156.2 Grade II	N/A	2-1/8"	1"	1" x 2-1/4"	1-3/8" - 1-3/4"	1-3/4" - 2-1/4"	Adjustable 2-3/8" or 2-3/4"	1/2"		

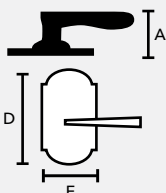

MODEL	A	B	C	D	E
Carlow Premiere	2-1/2"	-	-	5"	2-3/4"
Carlow Square	2-1/2"	-	-	5"	2-3/4"
Boulder Square	2-3/4"	-	-	5"	2-3/4"

CLASSIFICATION KEY

- A - Projection from Door
- B - Center to Center
- C - Footscrew
- D - Full Length
- E - Width of Rose (Escutcheon Plate)



PREMIERE DEADBOLT

HANDING	MODEL #	DESCRIPTION	PKG.	CASE WT	CASE QTY	1	2
-	7571	Single Cylinder	Box	30	15	92.00	92.00
-	7572	Double Cylinder	Box	36	15	104.00	104.00



SQUARE DEADBOLT

HANDING	MODEL #	DESCRIPTION	PKG.	CASE WT	CASE QTY	1	2
-	7971	Single Cylinder	Box	31	15	92.00	92.00
-	7972	Double Cylinder	Box	37	15	104.00	104.00

GENERAL SPECIFICATIONS

PRODUCT CATEGORY	CYLINDER		STRIKES		FACEPLATES		DOOR HANDING	ADA	ANSI	UL	BORING REQUIREMENTS			DOOR THICKNESS		BACKSET	LATCH BOLT THROW		
	STANDARD	OPTIONAL	DEADBOLT	HANDLE	STANDARD	OPTIONAL					CROSS BORE		EDGE BORE	LATCH FACE	STANDARD		SPECIAL	DEADBOLT	HANDLE
											DEADBOLT	HANDLE							
Deadbolts	5 Pin Weslock Keyway	5 Pin Schlage C or Kwikset Keyway	1" x 2-1/4", Radius & Square		1" x 2-1/4", Removable Radius & Square	Drive-in 1" x 2-1/4", Removable Radius & Square	Reversible for right or left-hand doors	N/A	A 156.2 Grade II	N/A	2-1/8" or 1-5/8"	1"	1" x 2-1/4"	1-3/8" - 1-3/4"	1-3/4" - 2-1/4"	Adjustable 2-3/8" or 2-3/4"	1"		



MODEL		A	B	C	D	E	
PREMIERE	7571 Single Cylinder	Interior	1-3/4"	-	-	4"	2-3/4"
		Exterior	3/4"	-	-	4"	2-3/4"
	7572 Double Cylinder	Interior	3/4"	-	-	4"	2-3/4"
		Exterior	3/4"	-	-	4"	2-3/4"
SQUARE	7971 Single Cylinder	Interior	1-3/4"	-	-	4"	2-3/4"
		Exterior	3/4"	-	-	4"	2-3/4"
	7972 Double Cylinder	Interior	3/4"	-	-	4"	2-3/4"
		Exterior	3/4"	-	-	4"	2-3/4"

CLASSIFICATION KEY

- A - Projection from Door
- B - Center to Center
- C - Footscrew
- D - Full Length
- E - Width of Rose (Escutcheon Plate)



GENERAL INFORMATION

PRODUCT DESCRIPTION CODES	2
---------------------------	---

COLLECTION PRICING & SPECIFICATIONS

ENTRY HANDLES	3-5
KNOBS	6
LEVERS	7
DEADBOLTS	8

Limited Lifetime Mechanical Warranty • Limited Lifetime Finish Warranty

[THE FOLLOWING TABLES DESCRIBE SPECIFIC PRODUCT DESCRIPTION
CODES THAT ARE UNIQUE TO EACH POSITION IN THE SYSTEM.]

**HANDING
POSITION 1**

Position 1 is used for indicating right (R) or left (L) handing of levers and handlesets when applicable. Use a zero (0) when handing is not required.

**MODEL NUMBERS
POSITIONS 2,3,4,5**

Positions 2, 3, 4 & 5 are used to indicate the model and function of knobs, levers, deadbolts and handlesets. For those products with only three (3) digit model numbers, place a zero (0) in position 2.

- Knobsets / Leversets: See model numbers on pages 6 & 7
- Deadbolts: See model numbers on page 8
- Handlesets: See model numbers on pages 3, 4 & 5

**EXTERIOR & INTERIOR KNOB & LEVER DESIGNS
POSITIONS 6 & 8**

KNOBS	CODE
Impresa	I
Julienne	J
LEVERS	CODE
Bordeáu	U
Ambassador	B
Urbana	2

**EXTERIOR & INTERIOR FINISH CODES
POSITIONS 7 & 9**

FINISHES	U.S.	BMA	WESLOCK
Bright Chrome	26	625	6
Satin Nickel	15	619	N
Oil Rubbed Bronze	10B	613	1
Matte Black	19	622	2

**LATCH CODES
POSITIONS 10 & 11**

CODE	LATCH
S L	2-3/8" or 2-3/4", Adjustable Latch Square & Radius Faceplate
D I	2-3/8" or 2-3/4", Adjustable Drive-in Latch Square & Radius Faceplates

**PACKAGING CODES
POSITION 12**

PACKAGING TYPES	CODE
Bulk Pack	0
Box Pack w/ Phillips Head Wood Screws	2
Retail Pack	X

**KEYING CODES
POSITION 13**

KEYING TYPES	CODE
Keyed Alike	A
Keyed Different	D
Master Keying charge per lock	M
Grand Master Keying charge per lock	G
Keying to Pass charge per lock	KTP
Home Guard charge per lock	HG
Owner Guard charge per lock (includes Master Key)	BK
Owner Guard charge per lock	OG
No Cylinder (zero)	0

**LATCH & STRIKE SCREWS
STANDARD**

No. 7x3/4" Phillips Head Sheet Metal Screws for wood doors.



MANSION®

HANDING	MODEL #	DESCRIPTION	PKG.	CASE WT	CASE QTY	6	N	1	2
-	6651	Exterior Handleset	Box	13	2	-	247.00	247.00	247.00
-	6655	Exterior Handleset-Dummy	Box	13	2	-	247.00	247.00	247.00
^R/L	6600	Interior Single Cylinder Trim	Box	13	4	-	107.00	107.00	107.00
^R/L	6602	Interior Double Cylinder Trim	Box	13	4	-	107.00	107.00	-
^R/L	6604	Interior Interconnect Trim	Box	13	4	-	179.00	179.00	-
^R/L	6605	Interior Dummy Trim	Box	13	4	-	107.00	107.00	107.00

Available with Impresa or Julienne knobs and Bordeáu or Ambassador levers.

^Handing required when interior trim uses a handed lever.



PHILBROOK

HANDING	MODEL #	DESCRIPTION	PKG.	CASE WT	CASE QTY	6	N	1	2
-	6641	Exterior Handleset	Box	15	2	-	283.00	283.00	-
-	6645	Exterior Handleset-Dummy	Box	15	2	-	283.00	283.00	-
^R/L	6600	Interior Single Cylinder Trim	Box	13	4	-	107.00	107.00	-
^R/L	6602	Interior Double Cylinder Trim	Box	15	4	-	107.00	107.00	-
^R/L	6604	Interior Interconnect Trim	Box	13	4	-	179.00	179.00	-
^R/L	6605	Interior Dummy Trim	Box	12	4	-	107.00	107.00	-

Available with Impresa or Julienne knobs and Bordeáu or Ambassador levers.

^Handing required when interior trim uses a handed lever.

GENERAL SPECIFICATIONS

PRODUCT CATEGORY	CYLINDER		STRIKES		FACEPLATES		DOOR HANDING	ADA	ANSI	UL	BORING REQUIREMENTS			DOOR THICKNESS		BACKSET	LATCH BOLT THROW			
	STANDARD	OPTIONAL	DEADBOLT	HANDLE	STANDARD	OPTIONAL					CROSS BORE		EDGE BORE	LATCH FACE	STANDARD		SPECIAL	DEADBOLT	HANDLE	
											DEADBOLT	HANDLE								
Handlesets	5 Pin Weslock Keyway	5 Pin Schlage C or Kwikset Keyway	2-1/4" full lip and 1" x 2-1/4" no lip, Radius & Square	2-1/4" full lip, Radius & Square	1" x 2-1/4", Removable Radius & Square	Drive-in 1" x 2-1/4", Removable Radius & Square	Specify handing on all interior trims with handed levers.	N/A	A 156.2 Grade II	N/A	2-1/8" or 1-5/8"	2-1/8"	1"	1" x 2-1/4"	1-3/4" - 2"	2" - 2-1/4"	Adjustable	2-3/8" or 2-3/4"	1"	1/2"

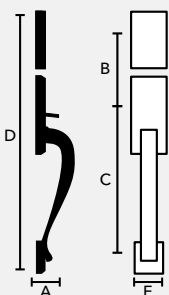

MODEL		A	B	C	D	E
Mansion	Interior	2-3/4"	5-1/2"	-	10-1/8"	2-3/4"
	Exterior	3"	5-1/2"	8-3/4" - 10"	18-1/2"	2-3/4"
Philbrook	Interior	2-3/4"	5-1/2"	-	10-1/8"	2-3/4"
	Exterior	2-3/4"	5-1/2"	8-3/4" - 10"	19-1/4"	2-3/4"

CLASSIFICATION KEY

- A - Projection from Door
- B - Center to Center
- C - Footscrew
- D - Full Length
- E - Width of Rose (Escutcheon Plate)

WOODWARD™



HANDING	MODEL #	DESCRIPTION	PKG.	CASE WT	CASE QTY	6	N	1	2
-	6681	Exterior Handleset	Box	14	2	-	264.00	264.00	264.00
-	6685	Exterior Handleset-Dummy	Box	14	2	-	264.00	264.00	264.00
^R/L	6200	Interior Single Cylinder Trim	Box	14	4	-	114.00	114.00	114.00
^R/L	6202	Interior Double Cylinder Trim	Box	16	4	-	114.00	114.00	-
^R/L	6204	Interior Interconnect Trim	Box	14	4	-	186.00	186.00	-
^R/L	6205	Interior Dummy Trim	Box	13	4	-	114.00	114.00	114.00

Available with Impresa or Julienne knobs and Urbana lever.

^Handing required when interior trim uses a handed lever.

BELMONT



HANDING	MODEL #	DESCRIPTION	PKG.	CASE WT	CASE QTY	6	N	1	2
-	6691	Exterior Handleset	Box	16	2	307.00	307.00	307.00	-
-	6695	Exterior Handleset-Dummy	Box	16	2	307.00	307.00	307.00	-
^R/L	6200	Interior Single Cylinder Trim	Box	14	4	114.00	114.00	114.00	-
^R/L	6202	Interior Double Cylinder Trim	Box	16	4	-	114.00	114.00	-
^R/L	6204	Interior Interconnect Trim	Box	14	4	-	186.00	186.00	-
^R/L	6205	Interior Dummy Trim	Box	13	4	114.00	114.00	114.00	-

Available with Impresa or Julienne knobs and Urbana lever.

^Handing required when interior trim uses a handed lever.

GENERAL SPECIFICATIONS

PRODUCT CATEGORY	CYLINDER		STRIKES		FACEPLATES		DOOR HANDING	ADA	ANSI	UL	BORING REQUIREMENTS			DOOR THICKNESS		BACKSET	LATCH BOLT THROW			
	STANDARD	OPTIONAL	DEADBOLT	HANDLE	STANDARD	OPTIONAL					CROSS BORE		EDGE BORE	LATCH FACE	STANDARD		SPECIAL	DEADBOLT	HANDLE	
											DEADBOLT	HANDLE								
Handlesets	5 Pin Weslock Keyway	5 Pin Schlage C or Kwikset Keyway	2-1/4" full lip and 1" x 2-1/4" no lip, Radius & Square	2-1/4" full lip, Radius & Square	1" x 2-1/4", Removable Radius & Square	Drive-in 1" x 2-1/4", Removable Radius & Square	Specify handing on all interior trims with handed levers.	N/A	A 156.2 Grade II	N/A	2-1/8" or 1-5/8"	2-1/8"	1"	1" x 2-1/4"	1-3/4" - 2"	2" - 2-1/4"	Adjustable	2-3/8" or 2-3/4"	1"	1/2"

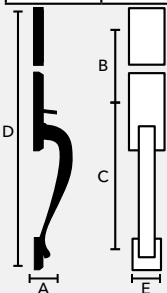

MODEL		A	B	C	D	E
Woodward	Interior	2-3/4"	5-1/2"	-	10-1/8"	2-3/4"
	Exterior	2-3/4"	5-1/2"	8-3/4" - 10"	18-1/4"	2-3/4"
Belmont	Interior	2-3/4"	5-1/2"	-	10-1/8"	2-3/4"
	Exterior	2-3/4"	5-1/2"	8-3/4" - 10"	19"	2-3/4"

CLASSIFICATION KEY

- A - Projection from Door
- B - Center to Center
- C - Footscrew
- D - Full Length
- E - Width of Rose (Escutcheon Plate)



BINGHAM INTERIOR TRIM INCLUDED

HANDING	MODEL #	DESCRIPTION	PKG.	CASE WT	CASE QTY	6	N	1	2
^R/L	6631	Single Cylinder Deadbolt Passage	Box	23	4	-	266.00	266.00	266.00
^R/L	6635	Dummy Handle (all parts rigid)	Box	23	4	-	266.00	266.00	266.00

Available with Impresa or Julienne knobs.

^Handing required with all knob styles.



ATTEBERRY INTERIOR TRIM INCLUDED

HANDING	MODEL #	DESCRIPTION	PKG.	CASE WT	CASE QTY	6	N	1	2
^R/L	6671	Single Cylinder Deadbolt Passage	Box	23	4	-	266.00	266.00	266.00
^R/L	6675	Dummy Handle (all parts rigid)	Box	23	4	-	266.00	266.00	266.00

Available with Impresa or Julienne knobs.

^Handing required with all knob styles.

GENERAL SPECIFICATIONS

PRODUCT CATEGORY	CYLINDER		STRIKES		FACEPLATES		DOOR HANDING	ADA	ANSI	UL	BORING REQUIREMENTS				DOOR THICKNESS		BACKSET	LATCH BOLT THROW	
	STANDARD	OPTIONAL	DEADBOLT	HANDLE	STANDARD	OPTIONAL					CROSS BORE		EDGE BORE	LATCH FACE	STANDARD	SPECIAL		DEADBOLT	HANDLE
											DEADBOLT	HANDLE							
Handlesets	5 Pin Weslock Keyway	5 Pin Schlage Cor Kwikset Keyway	2-1/4" full lip and 1" x 2-1/4" no lip, Radius & Square	2-1/4" full lip, Radius & Square	1" x 2-1/4", Radius & Square	Drive-in 1" x 2-1/4", Removable Radius & Square	Specify handing on all functions.	N/A	A 156.2 Grade II	N/A	2-1/8" or 1-5/8"	2-1/8"	1"	1" x 2-1/4"	1-3/4" - 2"	2" - 2-1/4"	Adjustable 2-3/8" or 2-3/4"	1"	1/2"

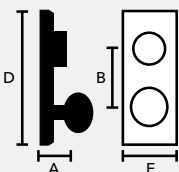

MODEL		A	B	C	D	E
Bingham	Interior	2-3/4"	5-1/2"	-	10-1/8"	2-3/4"
	Exterior	2-3/4"	5-1/2"	-	10-1/4"	2-3/4"
Atteberry	Interior	2-3/4"	5-1/2"	-	10-1/8"	2-3/4"
	Exterior	2-3/4"	5-1/2"	-	10-1/4"	2-3/4"

CLASSIFICATION KEY

- A - Projection from Door
- B - Center to Center
- C - Footscrew
- D - Full Length
- E - Width of Rose (Escutcheon Plate)

IMPRESA™ KNOB (I)



	HANDING	MODEL #	DESCRIPTION	PKG.	CASE WT	CASE QTY	N	1	2
PREMIERE	-	1700	Passage (Hall & Closet)	Box	31	15	60.20	60.20	-
	-	1705	Dummy Knob	Box	22	30	27.10	27.10	-
	-	1710	Privacy (Bed & Bath)	Box	33	15	63.80	63.80	-
	-	1740	Keylock (Keyed Entry)	Box	36	15	84.20	84.20	-
WOODWARD	-	3700	Passage (Hall & Closet)	Box	32	15	60.20	60.20	60.20
	-	3705	Dummy Knob	Box	21	30	27.10	27.10	27.10
	-	3710	Privacy (Bed & Bath)	Box	34	15	63.80	63.80	63.80
	-	3740	Keylock (Keyed Entry)	Box	37	15	84.20	84.20	84.20

JULIENNE KNOB (J)



	HANDING	MODEL #	DESCRIPTION	PKG.	CASE WT	CASE QTY	N	1	2
PREMIERE	-	1700	Passage (Hall & Closet)	Box	31	15	70.30	70.30	-
	-	1705	Dummy Knob	Box	20	30	32.60	32.60	-
	-	1710	Privacy (Bed & Bath)	Box	33	15	73.40	73.40	-
	-	1740	Keylock (Keyed Entry)	Box	36	15	101.00	101.00	-

GENERAL SPECIFICATIONS

PRODUCT CATEGORY	CYLINDER		STRIKES		FACEPLATES		DOOR HANDING	ADA	ANSI	UL	BORING REQUIREMENTS			DOOR THICKNESS		BACKSET	LATCH BOLT THROW		
	STANDARD	OPTIONAL	DEADBOLT	HANDLE	STANDARD	OPTIONAL					CROSS BORE		EDGE BORE	LATCH FACE	STANDARD		SPECIAL	DEADBOLT	HANDLE
											DEADBOLT	HANDLE							
Knobs	5 Pin Weslock Keyway	5 Pin Schlage C or Kwikset Keyway	2-1/4" full lip, Radius & Square		1" x 2-1/4", Removable Radius & Square	Drive-in 1" x 2-1/4", Removable Radius & Square	Reversible for right or left-hand doors	N/A	A 156.2 Grade II	N/A	2-1/8"	1"	1" x 2-1/4"	1-3/8" - 1-3/4"	1-3/4" - 2-1/4"	Adjustable 2-3/8" or 2-3/4"	1/2"		

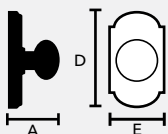

MODEL	A	B	C	D	E
Impresa	2-1/4"	-	-	5"	2-1/2"
Julienne	2-1/2"	-	-	5"	2-1/2"

CLASSIFICATION KEY

- A - Projection from Door
- B - Center to Center
- C - Footscrew
- D - Full Length
- E - Width of Rose (Escutcheon Plate)

BORDEÁU™ HANDED LEVERSETS (U)

Specify Right or Left when ordering



	HANDING	MODEL #	DESCRIPTION	PKG.	CASE WT	CASE QTY	6	N	1	2
PREMIERE	-	1700	Passage (Hall & Closet)	Box	33	12	-	85.40	85.40	-
	R/L	1705	Dummy Lever	Box	27	30	-	42.20	42.20	-
	-	1710	Privacy (Bed & Bath)	Box	34	12	-	88.90	88.90	-
	R/L	1740	Keylock (Keyed Entry)	Box	32	12	-	115.50	115.50	-

URBANA NON-HANDED LEVERSETS (2)



	HANDING	MODEL #	DESCRIPTION	PKG.	CASE WT	CASE QTY	6	N	1	2
WOODWARD	-	3700	Passage (Hall & Closet)	Box	29	12	85.40	85.40	85.40	85.40
	-	3705	Dummy Lever	Box	27	30	42.20	42.20	42.20	42.20
	-	3710	Privacy (Bed & Bath)	Box	30	12	88.90	88.90	88.90	88.90
	-	N/A	Keylock (Keyed Entry)	-	-	-	-	-	-	-

AMBASSADOR™ NON-HANDED LEVERSETS (B)



	HANDING	MODEL #	DESCRIPTION	PKG.	CASE WT	CASE QTY	6	N	1	2
PREMIERE	-	1700	Passage (Hall & Closet)	Box	37	12	-	89.00	89.00	-
	-	1705	Dummy Lever	Box	27	30	-	44.50	44.50	-
	-	1710	Privacy (Bed & Bath)	Box	35	12	-	92.70	92.70	-
	-	1740	Keylock (Keyed Entry)	Box	37	12	-	119.10	119.10	-

GENERAL SPECIFICATIONS

PRODUCT CATEGORY	CYLINDER		STRIKES		FACEPLATES		DOOR HANDING	ADA	ANSI	UL	BORING REQUIREMENTS			DOOR THICKNESS		BACKSET	LATCH BOLT THROW		
	STANDARD	OPTIONAL	DEADBOLT	HANDLE	STANDARD	OPTIONAL					CROSS BORE		EDGE BORE	LATCH FACE	STANDARD		SPECIAL	DEADBOLT	HANDLE
											DEADBOLT	HANDLE							
Levers	5 Pin Weslock Keyway	5 Pin Schlage C or Kwikset Keyway	2-1/4" full lip, Radius & Square		1" x 2-1/4", Removable Radius & Square	Drive-in 1" x 2-1/4", Removable Radius & Square	Specify handing for Bordeáu levers, all other styles are reversible for right or left-hand doors	All Functions Meet Sec. 4.13.9	A 156.2 Grade II	N/A	2-1/8"	1"	1" x 2-1/4"	1-3/8" - 1-3/4"	1-3/4" - 2-1/4"	Adjustable 2-3/8" or 2-3/4"	1/2"		

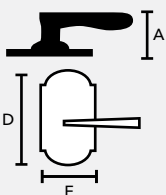

MODEL	A	B	C	D	E
Bordeáu Handed Leverset	2"	-	-	5"	2-1/2"
Ambassador Non-Handed Leverset	2-1/2"	-	-	5"	2-1/2"
Urbana Non-Handed Leverset	2-3/8"	-	-	5"	2-1/2"

CLASSIFICATION KEY

- A - Projection from Door
- B - Center to Center
- C - Footscrew
- D - Full Length
- E - Width of Rose (Escutcheon Plate)



PREMIERE DEADBOLT

HANDING	MODEL #	DESCRIPTION	PKG.	CASE WT	CASE QTY	6	N	1	2
-	1771	Single Cylinder	Box	27	15	-	70.40	70.40	-
-	1772	Double Cylinder	Box	28	15	-	75.20	75.20	-



WOODWARD™ DEADBOLT

HANDING	MODEL #	DESCRIPTION	PKG.	CASE WT	CASE QTY	6	N	1	2
-	3771	Single Cylinder	Box	28	15	70.40	70.40	70.40	70.40
-	3772	Double Cylinder	Box	29	15	75.20	75.20	75.20	-

GENERAL SPECIFICATIONS

PRODUCT CATEGORY	CYLINDER		STRIKES		FACEPLATES		DOOR HANDING	ADA	ANSI	UL	BORING REQUIREMENTS			DOOR THICKNESS		BACKSET	LATCH BOLT THROW	
	STANDARD	OPTIONAL	DEADBOLT	HANDLE	STANDARD	OPTIONAL					CROSS BORE		EDGE BORE	LATCH FACE	STANDARD		SPECIAL	DEADBOLT
											DEADBOLT	HANDLE						
Deadbolts	5 Pin Weslock Keyway	5 Pin Schlage C or Kwikset Keyway	1" x 2-1/4", Radius & Square		1" x 2-1/4", Removable Radius & Square	Drive-in 1" x 2-1/4", Removable Radius & Square	Reversible for right or left-hand doors	N/A	A 156.2 Grade II	N/A	2-1/8"		1"	1" x 2-1/4"	1-3/8" - 1-3/4"	1-3/4" - 2-1/4"	Adjustable 2-3/8" or 2-3/4"	1"



MODEL		A	B	C	D	E	
Premiere	1771 Single Cylinder	Interior	1-3/4"	-	-	3-7/8"	2-3/4"
		Exterior	7/8"	-	-	3-7/8"	2-3/4"
	1772 Double Cylinder	Interior	7/8"	-	-	3-7/8"	2-3/4"
		Exterior	7/8"	-	-	3-7/8"	2-3/4"
Woodward	3771 Single Cylinder	Interior	1-3/4"	-	-	3-7/8"	2-3/4"
		Exterior	7/8"	-	-	3-7/8"	2-3/4"
	3772 Double Cylinder	Interior	7/8"	-	-	3-7/8"	2-3/4"
		Exterior	7/8"	-	-	3-7/8"	2-3/4"

CLASSIFICATION KEY

- A - Projection from Door
- B - Center to Center
- C - Footscrew
- D - Full Length
- E - Width of Rose (Escutcheon Plate)





GENERAL INFORMATION

PRODUCT DESCRIPTION CODES 2

COLLECTION PRICING & SPECIFICATIONS

ENTRY HANDLES 3-4

KNOBS 5

LEVERS 6

DEADBOLTS 7

Limited Lifetime Mechanical Warranty • Limited Lifetime Finish Warranty

[THE FOLLOWING TABLES DESCRIBE SPECIFIC PRODUCT DESCRIPTION
CODES THAT ARE UNIQUE TO EACH POSITION IN THE SYSTEM.]

**HANDING
POSITION 1**

Position 1 is used for indicating right (R) or left (L) handing of levers and handlesets when applicable. Use a zero (0) when handing is not required.

**MODEL NUMBERS
POSITIONS 2,3,4,5**

Positions 2, 3, 4 & 5 are used to indicate the model and function of knobs, levers, deadbolts and handlesets. For those products with only three (3) digit model numbers, place a zero (0) in position 2.

- Knobsets / Leversets: See model numbers on pages 5 & 6
- Deadbolts: See model numbers on page 7
- Handlesets: See model numbers on page 3 & 4

**EXTERIOR & INTERIOR KNOB & LEVER DESIGNS
POSITIONS 6 & 8**

KNOB	CODE
Eleganti	E
Impresa	I
Julienne	J
Savannah	Z
LEVERS	CODE
Ambassador	B
Bordeáu	U
Urbana	2

**EXTERIOR & INTERIOR FINISH CODES
POSITIONS 7 & 9**

FINISHES	U.S.	BMA	WESLOCK
Polished Brass	3	605	3
Lifetime Polished Brass (PVD)	L03	605E	B
Antique Brass	5	609	A
Bright Chrome	26	625	6
Satin Chrome	26D	626	D
Satin Nickel	15	619	N
Oil Rubbed Bronze	10B	613	1
Matte Black	19	622	2

**LATCH CODES - STANDARD
POSITIONS 10 & 11**

CODE	LATCH
SL	2-3/8" or 2-3/4" Adjustable Latch Square & Radius Faceplates
DI	2-3/8" or 2-3/4" Adjustable Drive-in Latch Square & Radius Faceplates

**PACKAGING CODES
POSITION 12**

PACKAGING TYPES	CODE
Bulk Pack	0
Box Pack w/ Phillips Head Wood Screws	2
Retail Pack	X

**KEYING CODES
POSITION 13**

KEYING TYPES	CODE
Keyed Alike	A
Keyed Different	D
Master Keying charge per lock	M
Grand Master Keying charge per lock	G
Keying to Pass charge per lock	KTP
Home Guard charge per lock	HG
Owner Guard charge per lock (includes Master Key)	BK
Owner Guard charge per lock	OG
No Cylinder (zero)	0

**LATCH & STRIKE SCREWS
STANDARD**

No. 7x3/4" Phillips Head Sheet Metal Screws for wood doors.

MODERNE 2100 SERIES



HANDING	MODEL #	DESCRIPTION	PKG.	CASE WT	CASE QTY	3 (B)	3	A	D	6	N	1	2
-	2165	Exterior Handleset	Box	20	4	-	-	-	-	281.90	281.90	-	281.90
-	2065	Exterior Handleset- Dummy	Box	20	4	-	-	-	-	281.90	281.90	-	281.90
^R/L	2110	Interior Single Cylinder Trim	Box	8	4	-	-	-	-	81.20	81.20	-	81.20
^R/L	2111	Interior Double Cylinder Trim	Box	9	4	-	-	-	-	81.20	81.20	-	81.20
^R/L	2112	Interior Dummy Trim	Box	7	4	-	-	-	-	81.20	81.20	-	81.20

Available with Impresa knob and Bordeáu or Urbana levers.

^Handing required when interior trim uses a handed lever.

LEXINGTON™ 2100 SERIES



HANDING	MODEL #	DESCRIPTION	PKG.	CASE WT	CASE QTY	3 (B)	3	A	D	6	N	1	2
-	2115	Exterior Handleset	Box	20	4	246.70	-	221.60	221.60	221.60	246.70	246.70	246.70
-	2105	Exterior Handleset- Dummy	Box	20	4	246.70	-	221.60	221.60	221.60	246.70	246.70	246.70
^R/L	2100	Interior Single Cylinder Trim	Box	8	4	-	80.70	76.80	76.80	76.80	82.00	82.00	82.00
^R/L	2109	Interior Double Cylinder Trim	Box	9	4	-	80.70	76.80	76.80	76.80	82.00	82.00	82.00
^R/L	2104	Interior Dummy Trim	Box	7	4	-	80.70	76.80	76.80	76.80	82.00	82.00	82.00

Available in any Traditionale Collection knob and lever style.

^Handing required when interior trim uses a handed lever.

COLONIAL™ 2100 SERIES



HANDING	MODEL #	DESCRIPTION	PKG.	CASE WT	CASE QTY	3 (B)	3	A	D	6	N	1	2
-	2175	Exterior Handleset	Box	21	4	-	-	246.70	-	-	-	-	-
-	2074	Exterior Handleset- Dummy	Box	21	4	-	-	246.70	-	-	-	-	-
^R/L	2100	Interior Single Cylinder Trim	Box	8	4	-	-	82.00	-	-	-	-	-
^R/L	2109	Interior Double Cylinder Trim	Box	9	4	-	-	82.00	-	-	-	-	-
^R/L	2104	Interior Dummy Trim	Box	7	4	-	-	82.00	-	-	-	-	-

Available with Impresa or Eleganti knobs and Bordeáu lever.

^Handing required when interior trim uses a handed lever.

GENERAL SPECIFICATIONS

PRODUCT CATEGORY	CYLINDER		STRIKES		FACEPLATES		DOOR HANDING	ADA	ANSI	UL	BORING REQUIREMENTS				DOOR THICKNESS		BACKSET	LATCH BOLT THROW		
	STANDARD	OPTIONAL	DEADBOLT	HANDLE	STANDARD	OPTIONAL					CROSS BORE		Edge Bore	Latch Face	Standard	Special		DEADBOLT	HANDLE	
											DEADBOLT	HANDLE								
2100 Series Entry Handles	5 Pin Weslock Keyway	5 Pin Schlage Cor Kwikset Keyway	2-1/4" full lip and 1" x 2-1/4" no lip, Radius & Square	2-1/4" full lip, Radius & Square	1" x 2-1/4", Removable Radius & Square	Drive-in 1" x 2-1/4", Removable Radius & Square	Specify handing on all interior trims with handed levers.	N/A	A 156.2 Grade II	N/A	2-1/8" or 1-5/8"	2-1/8"	1"	1" x 2-1/4"	1-3/4" - 2"	2" - 2-1/4"	Adjustable	2-3/8" or 2-3/4"	1"	1/2"

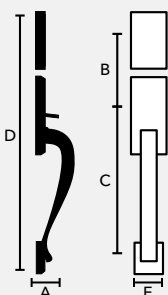

MODEL	A	B	C	D	E
2100 Moderne	2-7/8"	5-1/2"	8-1/2"-9-3/4"	18"	2-3/4"
2100 Lexington	2-7/8"	5-1/2"	9-1/4"	18"	2-3/4"
2100 Colonial	2-1/2"	5-1/2"	9-1/4"	18"	2-3/4"

CLASSIFICATION KEY

- A - Projection from Door
- B - Center to Center
- C - Footscrew
- D - Full Length
- E - Width of Rose (Escutcheon Plate)



(Two-point locking)

LEXINGTON™ 1300 SERIES

HANDING	MODEL #	DESCRIPTION	PKG.	CASE WT	CASE QTY	3 (B)	3	A	D	6	N	1	2
-	1343	Exterior Handleset	Box	19	4	335.00	-	335.00	-	-	335.00	335.00	-
-	1345	Exterior Handleset-Dummy	Box	19	4	335.00	-	335.00	-	-	355.00	335.00	-
^R/L	1300	Interior Single Cylinder Trim	Box	13	4	-	105.00	105.00	-	-	115.00	115.00	-
^R/L	1302	Interior Double Cylinder Trim	Box	14	4	-	105.00	105.00	-	-	115.00	115.00	-
^R/L	1305	Interior Dummy Trim	Box	12	4	-	105.00	105.00	-	-	115.00	115.00	-

Available with Impresa or Eleganti knobs and Bordeau lever.

^Handing required when interior trim uses a handed lever.

[REQUIRES 8" CENTER TO CENTER.
WILL NOT FIT 5-1/2" CENTER TO CENTER.]



(Two-point locking)

COLONIAL™ 1300 SERIES

HANDING	MODEL #	DESCRIPTION	PKG.	CASE WT	CASE QTY	3 (B)	3	A	D	6	N	1	2
-	1313	Exterior Handleset	Box	18	4	-	-	310.00	-	-	-	-	-
-	1315	Exterior Handleset-Dummy	Box	18	4	-	-	310.00	-	-	-	-	-
^R/L	1300	Interior Single Cylinder Trim	Box	13	4	-	-	105.00	-	-	-	-	-
^R/L	1302	Interior Double Cylinder Trim	Box	14	4	-	-	105.00	-	-	-	-	-
^R/L	1305	Interior Dummy Trim	Box	12	4	-	-	105.00	-	-	-	-	-

Available with Impresa or Eleganti knobs and Bordeau lever.

^Handing required when interior trim uses a handed lever.

[REQUIRES 8" CENTER TO CENTER.
WILL NOT FIT 5-1/2" CENTER TO CENTER.]

GENERAL SPECIFICATIONS

PRODUCT CATEGORY	CYLINDER		STRIKES		FACEPLATES		DOOR HANDING	ADA	ANSI	UL	BORING REQUIREMENTS				DOOR THICKNESS		BACKSET	LATCH BOLT THROW	
	STANDARD	OPTIONAL	DEADBOLT	HANDLE	STANDARD	OPTIONAL					CROSS BORE		Edge Bore	Latch Face	Standard	Special		DEADBOLT	HANDLE
											DEADBOLT	HANDLE							
1300 Series Entry Handles	5 Pin Weslock Keyway	5 Pin Kwikset Keyway	2-1/4" full lip and 1" x 2-1/4" no lip, Radius & Square	2-1/4" full lip, Radius & Square	1" x 2-1/4", Removable Radius & Square	Drive-in 1" x 2-1/4", Removable Radius & Square	Specify handing on all interior trims with handed levers.	N/A	A 156.2 Grade II	N/A	2-1/8" or 1-5/8" (8" CXC)	2-1/8" (8" CXC)	1" (8" CXC)	1" x 2-1/4"	1-3/4" - 2"	2" - 2-1/4"	Adjustable 2-3/8" or 2-3/4"	1"	1/2"

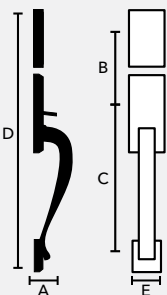

MODEL	A	B	C	D	E
1300 Lexington	2-7/8"	*8"	8-3/16"	19-1/2"	3-3/8"
1300 Colonial	2-1/2"	*8"	8-3/16"	19-1/2"	3-1/6"

* REQUIRES 8" CENTER TO CENTER MINIMUM

CLASSIFICATION KEY

- A - Projection from Door
- B - Center to Center
- C - Footscrew
- D - Full Length
- E - Width of Rose (Escutcheon Plate)

JULIENNE KNOB (J)



HANDING	MODEL #	DESCRIPTION	PKG.	CASE WT	CASE QTY	3 (B)	3	A	D	6	N	1	2
-	0600	Passage (Hall & Closet)	Box	37	30	-	-	-	-	-	51.00	51.00	-
-	0605	Dummy Knob	Box	11	30	-	-	-	-	-	22.30	22.30	-
-	0610	Privacy (Bed & Bath)	Box	40	30	-	-	-	-	-	55.20	55.20	-
-	0640	Keylock (Keyed Entry)	Box	46	30	-	-	-	-	-	82.80	82.80	-

ELEGANTI™ KNOB (E)



HANDING	MODEL #	DESCRIPTION	PKG.	CASE WT	CASE QTY	3 (B)	3	A	D	6	N	1	2
-	0600	Passage (Hall & Closet)	Box	37	30	-	-	45.10	-	-	-	-	-
-	0605	Dummy Knob	Box	11	30	-	-	19.80	-	-	-	-	-
-	0610	Privacy (Bed & Bath)	Box	40	30	-	-	48.00	-	-	-	-	-
-	0640	Keylock (Keyed Entry)	Box	46	30	-	-	71.80	-	-	-	-	-

SAVANNAH™ KNOB (Z)



HANDING	MODEL #	DESCRIPTION	PKG.	CASE WT	CASE QTY	3 (B)	3	A	D	6	N	1	2
-	0600	Passage (Hall & Closet)	Box	37	30	-	-	-	-	-	41.00	41.00	-
-	0605	Dummy Knob	Box	11	30	-	-	-	-	-	17.80	17.80	-
-	0610	Privacy (Bed & Bath)	Box	40	30	-	-	-	-	-	44.50	44.50	-
-	0640	Keylock (Keyed Entry)	Box	46	30	-	-	-	-	-	66.10	66.10	-

IMPRESA™ KNOB (I)



HANDING	MODEL #	DESCRIPTION	PKG.	CASE WT	CASE QTY	3 (B)	3	A	D	6	N	1	2
-	0600	Passage (Hall & Closet)	Box	37	30	-	33.40	37.00	37.00	37.00	39.00	39.00	39.00
-	0605	Dummy Knob	Box	11	30	-	14.50	15.90	15.90	15.90	17.00	17.00	17.00
-	0606	Dummy Passage Set	Box	32	30	-	29.00	31.80	31.80	31.80	34.00	34.00	34.00
-	0610	Privacy (Bed & Bath)	Box	40	30	-	36.80	40.40	40.40	40.40	43.10	43.10	43.10
-	0640	Keylock (Keyed Entry)	Box	46	30	61.00	-	61.00	61.00	61.00	64.70	64.70	64.70
-	0642	Vestibule Keylock	Box	45	30	61.00	-	61.00	61.00	61.00	64.70	64.70	64.70

GENERAL SPECIFICATIONS

PRODUCT CATEGORY	CYLINDER		STRIKES		FACEPLATES		DOOR HANDING	ADA	ANSI	UL	BORING REQUIREMENTS				DOOR THICKNESS		BACKSET	LATCH BOLT THROW	
	STANDARD	OPTIONAL	DEADBOLT	HANDLE	STANDARD	OPTIONAL					CROSS BORE		Edge Bore	Latch Face	Standard	Special		DEADBOLT	HANDLE
											DEADBOLT	HANDLE							
Knobs	5 Pin Weslock Keyway	5 Pin Schlage Cor Kwikset Keyway	2-1/4" full lip, Radius & Square		1" x 2-1/4", Removable Radius & Square	Drive-in 1" x 2-1/4", Removable Radius & Square	Reversible for right or left-hand doors	N/A	A 156.2 Grade II	N/A	2-1/8"	1"	1" x 2-1/4"	1-3/8" - 1-3/4"	1-3/4" - 2-1/4"	Adjustable 2-3/8" or 2-3/4"	1/2"		



MODEL	A	B	C	D	E
Eleganti	2-1/8"	-	-	-	2-1/2"
Impresa	2-1/8"	-	-	-	2-1/2"
Julienne	2-1/2"	-	-	-	2-1/2"
Savannah	2-1/8"	-	-	-	2-1/2"

CLASSIFICATION KEY

- A - Projection from Door
- B - Center to Center
- C - Footscrew
- D - Full Length
- E - Width of Rose (Escutcheon Plate)

AMBASSADOR™ NON-HANDED LEVERSETS (B)



HANDING	MODEL #	DESCRIPTION	PKG.	CASE WT	CASE QTY	3 (B)	3	A	D	6	N	1	2
-	0600	Passage (Hall & Closet)	Box	23	12	-	-	-	-	-	67.30	67.30	-
-	0605	Dummy Lever	Box	11	30	-	-	-	-	-	33.10	33.10	-
-	0610	Privacy (Bed & Bath)	Box	25	12	-	-	-	-	-	72.00	72.00	-
-	0640	Keylock (Keyed Entry)	Box	25	12	-	-	-	-	-	103.80	103.80	-

BORDEAU™ LEVERSETS (U)

Specify Right or Left when ordering dummy and keylock functions



HANDING	MODEL #	DESCRIPTION	PKG.	CASE WT	CASE QTY	3 (B)	3	A	D	6	N	1	2
-	0600	Passage (Hall & Closet)	Box	47	12	-	56.00	59.20	59.20	59.20	62.80	62.80	62.80
R/L	0605	Dummy Lever	Box	17	30	-	26.50	28.50	28.50	28.50	31.60	31.60	31.60
-	0610	Privacy (Bed & Bath)	Box	50	12	-	60.00	63.20	63.20	63.20	67.80	67.80	67.80
R/L	0640	Keylock (Keyed Entry)	Box	24	12	98.40	-	96.30	96.30	96.30	98.40	98.40	98.40

URBANA NON-HANDED LEVERSETS (2)



HANDING	MODEL #	DESCRIPTION	PKG.	CASE WT	CASE QTY	3 (B)	3	A	D	6	N	1	2
-	0600	Passage (Hall & Closet)	Box	23	12	-	-	-	-	59.20	62.80	62.80	-
-	0605	Dummy Lever	Box	17	30	-	-	-	-	28.50	31.60	31.60	-
-	0610	Privacy (Bed & Bath)	Box	24	12	-	-	-	-	63.20	67.80	67.80	-
-	N/A	Keylock (Keyed Entry)	-	-	-	-	-	-	-	-	-	-	-

GENERAL SPECIFICATIONS

PRODUCT CATEGORY	CYLINDER		STRIKES		FACEPLATES		DOOR HANDING	ADA	ANSI	UL	BORING REQUIREMENTS				DOOR THICKNESS		BACKSET	LATCH BOLT THROW	
	STANDARD	OPTIONAL	DEADBOLT	HANDLE	STANDARD	OPTIONAL					CROSS BORE		Edge Bore	Latch Face	Standard	Special		DEADBOLT	HANDLE
											DEADBOLT	HANDLE							
Levers	5 Pin Weslock Keyway	5 Pin Schlage C or Kwikset Keyway	2-1/4" full lip, Radius & Square		1" x 2-1/4", Removable Radius & Square	Drive-in 1" x 2-1/4", Removable Radius & Square	Specify handing for Bordeaux levers, all other styles are reversible for right or left-hand doors	All Functions Meet Sec. 4.13.9	A 156.2 Grade II	N/A	2-1/8"		1"	1" x 2-1/4"	1-3/8" - 1-3/4"	1-3/4" - 2-1/4"	Adjustable 2-3/8" or 2-3/4"	1/2"	



MODEL	A	B	C	D	E
Ambassador Non-Handed Leverset	2-1/4"	-	-	-	2-1/2"
Bordeau Handed Leverset	2-3/8"	-	-	-	2-1/2"
Urbana Non-Handed Leverset	2-3/8"	-	-	-	2-1/2"

CLASSIFICATION KEY

A - Projection from Door

B - Center to Center

C - Footscrew

D - Full Length

E - Width of Rose (Escutcheon Plate)



EXTRA HEAVY DUTY SINGLE & DOUBLE CYLINDER DEADBOLTS

HANDING	MODEL #	DESCRIPTION	PKG.	CASE WT	CASE QTY	3 (B)	3	A	D	6	N	1	2
-	0671	Single Cylinder	Box	52	30	61.10	-	61.10	61.10	61.10	63.90	63.90	-
-	0672	Double Cylinder	Box	72	30	78.60	-	78.60	78.60	78.60	-	-	-



SINGLE & DOUBLE CYLINDER DEADBOLTS

HANDING	MODEL #	DESCRIPTION	PKG.	CASE WT	CASE QTY	3 (B)	3	A	D	6	N	1	2
-	0371	Single Cylinder	Box	42	30	45.70	-	45.70	45.70	45.70	48.70	48.70	48.70
-	0372	Double Cylinder	Box	48	30	60.80	-	60.80	60.80	60.80	64.60	64.60	64.60



NON-CYLINDER DEADBOLTS

HANDING	MODEL #	DESCRIPTION	PKG.	CASE WT	CASE QTY	3 (B)	3	A	D	6	N	1	2
-	0667	Non-Cylinder	Box	25	30	-	27.40	29.30	29.30	-	-	-	-

GENERAL SPECIFICATIONS

PRODUCT CATEGORY	CYLINDER		STRIKES		FACEPLATES		DOOR HANDING	ADA	ANSI	UL	BORING REQUIREMENTS				DOOR THICKNESS		BACKSET	LATCH BOLT THROW	
	STANDARD	OPTIONAL	DEADBOLT	HANDLE	STANDARD	OPTIONAL					CROSS BORE		Edge Bore	Latch Face	Standard	Special		DEADBOLT	HANDLE
											DEADBOLT	HANDLE							
660/670 Series Deadbolts	5 Pin Weslock Keyway	5 Pin Schlage Cor Kwikset Keyway	1" x 2-1/4", Radius & Square		1" x 2-1/4", Removable Radius & Square	Drive-in 1" x 2-1/4", Removable Radius & Square	Reversible for right or left-hand doors	Yes	A 156.2 Grade II	N/A	2-1/8"	1"	1" x 2-1/4"	1-3/8" - 2"	2" - 2-1/4"	Adjustable 2-3/8" or 2-3/4"	1"		
370 Series Deadbolts	5 Pin Weslock Keyway	5 Pin Schlage Cor Kwikset Keyway	1" x 2-1/4", Radius & Square		1" x 2-1/4", Removable Radius & Square	Drive-in 1" x 2-1/4", Removable Radius & Square	Reversible for right or left-hand doors	Yes	A 156.2 Grade II	N/A	2-1/8"	1"	1" x 2-1/4"	1-3/8" - 2"	2" - 2-1/4"	Adjustable 2-3/8" or 2-3/4"	1"		



MODEL		A	B	C	D	E
671	Single Cylinder	Interior	7/8"	-	-	2-3/4"
	Exterior	7/8"	-	-	-	2-3/4"
672	Double Cylinder	Interior	7/8"	-	-	2-3/4"
	Exterior	7/8"	-	-	-	2-3/4"
667	Single Non-Cylinder	Interior	7/8"	-	-	2-3/4"
	Exterior	-	-	-	-	-
371	Single Cylinder	Interior	7/8"	-	-	2-1/2"
	Exterior	1"	-	-	-	2-1/2"
372	Double Cylinder	Interior	1"	-	-	2-1/2"
	Exterior	1"	-	-	-	2-1/2"

CLASSIFICATION KEY

- A - Projection from Door
- B - Center to Center
- C - Footscrew
- D - Full Length
- E - Width of Rose (Escutcheon Plate)





GENERAL INFORMATION

PRODUCT DESCRIPTION CODES 2

COLLECTION PRICING & SPECIFICATIONS

1400 SERIES ENTRY HANDLES 3

1500 SERIES UNIGARD 4

Limited Lifetime Mechanical Warranty • Limited Lifetime Finish Warranty

[THE FOLLOWING TABLES DESCRIBE SPECIFIC PRODUCT DESCRIPTION
CODES THAT ARE UNIQUE TO EACH POSITION IN THE SYSTEM.]

**HANDING
POSITION 1**

Position 1 is used for indicating right (R) or left (L) handing of levers and handlesets when applicable. Use a zero (0) when handing is not required.

**MODEL NUMBERS
POSITIONS 2,3,4,5**

Positions 2, 3, 4 & 5 are used to indicate the model and function of knobs, levers, deadbolts and handlesets. For those products with only three (3) digit model numbers, place a zero (0) in position 2.

- Handlesets: See model numbers on page 3 & 4

**EXTERIOR & INTERIOR KNOB & LEVER DESIGNS
POSITION 6 & 8**

KNOBS	CODE
Eleganti	E
Impresa	I
Julienne	J
Savannah	Z
LEVERS	CODE
Ambassador	B
Bordeáu	U
Urbana	2

**EXTERIOR & INTERIOR FINISH CODES
POSITIONS 7 & 9**

FINISHES	U.S.	BMA	WESLOCK
Polished Brass	3	605	3
Lifetime Polished Brass (PVD)	L03	605E	B
Antique Brass	5	609	A
Satin Chrome	26D	626	D
Satin Nickel	15	619	N
Oil Rubbed Bronze	10B	613	1

**LATCH & STRIKE SCREWS
STANDARD**

No. 7x3/4" Phillips Head Sheet Metal Screws for wood doors.

**LATCH CODES - 1501 UNIGARD®
POSITIONS 10 & 11**

CODE	LATCH
SL	2-3/8" or 2-3/4", Non-Adjustable Latches Square & Radius Faceplates
DI	2-3/8" or 2-3/4", Non-Adjustable Drive-in Latches No Faceplates

**LATCH CODES - 1400SERIES ENTRY HANDLES & 1510 UNIGARD®
POSITIONS 10 & 11**

CODE	LATCH
38	2-3/8" Non-Adjustable Latches Square & Radius Faceplates
34	2-3/4" Non-Adjustable Latches Square & Radius Faceplates

**PACKAGING CODES
POSITION 12**

PACKAGING TYPES	CODE
Bulk Pack	0
Box Pack w/ Phillips Head Wood Screws	2

**KEYING CODES
POSITION 13**

KEYING TYPES	CODE
Keyed Alike	A
Keyed Different	D
Master Keying charge per lock	M
Grand Master Keying charge per lock	G
Keying to Pass charge per lock	KTP
Home Guard charge per lock	HG
Owner Guard charge per lock (includes Master Key)	BK
Owner Guard charge per lock	OG
No Cylinder (zero)	0

LEXINGTON™ 1400 SERIES



HANDING	MODEL #	DESCRIPTION	PKG.	CASE WT	CASE QTY	3 (B)	3	A	D	6	N	1	2
-	1441	Exterior Handleset	Box	23	4	280.00	-	280.00	-	-	280.00	280.00	-
-	1445	Exterior Handleset-Dummy	Box	23	4	280.00	-	280.00	-	-	280.00	280.00	-
^R/L	1401	Interior Single Cylinder Trim	Box	11	4	-	109.00	109.00	-	-	109.00	109.00	-
^R/L	1405	Interior Dummy Trim	Box	8	4	-	109.00	109.00	-	-	109.00	109.00	-

Available in any Traditionale Collection knob and lever style.

^Handing required when interior trim uses a handed lever.

**[REQUIRES 2-7/8" CENTER TO CENTER.
WILL NOT FIT 5-1/2" CENTER TO CENTER.]**

(Single-point locking & Interconnect)

COLONIAL™ 1400 SERIES



HANDING	MODEL #	DESCRIPTION	PKG.	CASE WT	CASE QTY	3 (B)	3	A	D	6	N	1	2
-	1411	Exterior Handleset	Box	21	4	-	-	280.00	-	-	-	-	-
-	1415	Exterior Handleset-Dummy	Box	21	4	-	-	280.00	-	-	-	-	-
^R/L	1401	Interior Single Cylinder Trim	Box	11	4	-	-	109.00	-	-	-	-	-
^R/L	1405	Interior Dummy Trim	Box	8	4	-	-	109.00	-	-	-	-	-

Available with Impresa and Eleganti knobs or Bordeáu lever.

^Handing required when interior trim uses a handed lever.

**[REQUIRES 2-7/8" CENTER TO CENTER.
WILL NOT FIT 5-1/2" CENTER TO CENTER.]**

(Single-point locking & Interconnect)

GENERAL SPECIFICATIONS

PRODUCT CATEGORY	CYLINDER		STRIKES		FACEPLATES		DOOR HANDING	ADA	ANSI	UL	BORING REQUIREMENTS				DOOR THICKNESS		BACKSET	LATCH BOLT THROW	
	STANDARD	OPTIONAL	DEADBOLT	HANDLE	STANDARD	OPTIONAL					CROSS BORE		Edge Bore	Latch Face	Standard	Special		DEADBOLT	HANDLE
											DEADBOLT	HANDLE							
1400 Series Entry Handles	5 Pin Weslock Keyway	5 Pin Schlage C Keyway	2-1/4" full lip and 1" x 2-1/4" no lip, Radius & Square	2-1/4" Full Lip, Radius & Square	1" x 2-1/4", Removable Radius or Square	Drive-in 1" x 2-1/4", Removable Radius or Square	Specify handing on all interior trims with handed levers.	N/A	N/A	N/A	2-1/8"	2-1/8"	1"	1" x 2-1/4"	1-3/4" - 2-1/4"	N/A	Non-adjustable 2-3/8" (optional 2-3/4")	1"	1/2"

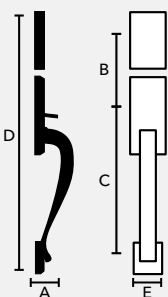

MODEL		A	B	C	D	E
1441 Lexington	Interior	2-3/4"	2-7/8"	-	6"	3-1/8"
	Exterior	2-13/16"	2-7/8"	8-3/16"	14-15/16"	3-1/2"
1411 Colonial	Interior	2-3/4"	2-7/8"	-	6"	3-1/8"
	Exterior	2-1/2"	2-7/8"	8-3/16"	14-7/16"	3-1/8"

CLASSIFICATION KEY

- A - Projection from Door
- B - Center to Center
- C - Footscrew
- D - Full Length
- E - Width of Rose (Escutcheon Plate)

UNIGARD® PREMIERE / INTERIOR TRIM INCLUDED



HANDING	MODEL #	DESCRIPTION	PKG.	CASE WT	CASE QTY	3 (B)	3	A	D	6	N	1	2
^R/L	1501	Key operated exterior, interconnected interior w/ thumbturn upper & passage, panic-proof lower knob. (Springlatch)	Box	18	4	251.00	-	251.00	251.00	-	251.00	-	-
^R/L	1510	With combined faceplate & ASA strikes (square only)	Box	18	4	280.00	-	280.00	280.00	-	280.00	-	-

Available in any Traditionale Collection knob and lever style.
 ^Handing required when interior trim uses a handed lever.

GENERAL SPECIFICATIONS

PRODUCT CATEGORY	CYLINDER		STRIKES		FACEPLATES		DOOR HANDING	ADA	ANSI	UL	BORING REQUIREMENTS				DOOR THICKNESS		BACKSET	LATCH BOLT THROW	
	STANDARD	OPTIONAL	DEADBOLT	HANDLE	STANDARD	OPTIONAL					CROSS BORE		Edge Bore	Latch Face	Standard	Special		DEADBOLT	HANDLE
											DEADBOLT	HANDLE							
1501 Unigard	5 Pin Weslock Keyway	5 Pin Schlage C or Kwikset Keyway	2-1/4" full lip and 1" x 2-1/4" no lip", Radius & Square	2-1/4" Full Lip, Radius & Square	1" x 2-1/4", Removable Radius or Square	Drive-in 1" x 2-1/4", Removable Radius or Square	Specify handing for handed levers, all others reversible for right or left hand doors.	N/A	N/A	N/A	2-1/8"	2-1/8"	1"	1" x 2-1/4"	1-1/2" - 2"	2" - 2-1/4"	Non-adjustable 2-3/8" (optional 2-3/4")	1"	1/2"
1510 Unigard	5 Pin Weslock Keyway	5 Pin Schlage C or Kwikset Keyway	1-1/4" x 4-7/8", Square (ASA strike)	N/A	Combined 4-1/4" x 1-1/8" Square	N/A	Specify handing for handed levers, all others reversible for right or left hand doors.	N/A	N/A	N/A	2-1/8"	2-1/8"	1"	1-1/8" x 4-1/4"	1-1/2" - 2"	2" - 2-1/4"	Non-adjustable 2-3/4" (optional 2-3/8")	1"	1/2"

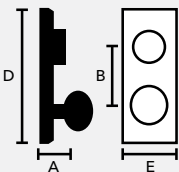

MODEL		A	B	C	D	E	
PREMIERE	Unigard 1501	Interior	2-3/4"	2-7/8"	-	6"	3-1/8"
		Exterior	2-5/8"	2-7/8"	-	8-1/8"	3-1/2"
	Unigard 1510	Interior	2-3/4"	*2-7/8"	-	6"	3-1/8"
		Exterior	2-5/8"	*2-7/8"	-	8-1/8"	3-1/2"

* EDGE BORE C X C IS 2-3/8"

CLASSIFICATION KEY

- A - Projection from Door
- B - Center to Center
- C - Footscrew
- D - Full Length
- E - Width of Rose (Escutcheon Plate)



GENERAL INFORMATION

PRODUCT DESCRIPTION CODES	2
---------------------------	---

COLLECTION PRICING & SPECIFICATIONS

ENTRY HANDLES	3-4
KNOBS	5
LEVERS	6
DEADBOLTS	7
KNOB/DEADBOLT COMBOS	8
LEVER/DEADBOLT COMBOS	8

Limited Twenty-Five Year Mechanical Warranty • Limited Five Year Finish Warranty

[THE FOLLOWING TABLES DESCRIBE SPECIFIC PRODUCT DESCRIPTION
CODES THAT ARE UNIQUE TO EACH POSITION IN THE SYSTEM.]

**HANDING
POSITION 1**

Position 1 is used for indicating right (R) or left (L) handing of levers and handlesets when applicable. Use a zero (o) when handing is not required.

**MODEL NUMBERS
POSITIONS 2,3,4,5**

Positions 2, 3, 4 & 5 are used to indicate the model and function of knobs, levers, deadbolts and handlesets. For those products with only three (3) digit model numbers, place a zero (o) in position 2.

- Knobsets / Leversets: See model numbers on page 5 & 6
- Deadbolts: See model numbers on page 7
- Handlesets: See model numbers on page 3 & 4
- Combos: See model numbers on page 8

**EXTERIOR & INTERIOR KNOB & LEVER DESIGNS
POSITIONS 6 & 8**

KNOB	CODE
Hudson	G
Salem	S
LEVERS (NON-HANDED)	CODE
Somerset	V
New Haven	X

**EXTERIOR & INTERIOR FINISH CODES
POSITIONS 7 & 9**

FINISHES	U.S.	BMA	WESLOCK
Satin Nickel	15	619	N
Oil Rubbed Bronze	10B	613	1
Bright Chrome	26	625	6
Matte Black	19	622	2

**LATCH CODES - STANDARD
POSITIONS 10 & 11**

CODE	LATCH
FR	2-3/8" or 2-3/4", Adjustable Latch Radius Faceplate
DI	2-3/8" or 2-3/4", Adjustable Drive-in Latch (No Faceplate)

**PACKAGING CODES
POSITION 12**

PACKAGING TYPES	CODE
Box Pack w/Phillips Head Wood Screws	Z
Retail Pack	V

**KEYING CODES
POSITION 13**

KEYING TYPES	CODE
Keyed Alike	A
Keyed Different	D
Master Keying charge per lock	M
Grand Master Keying charge per lock	G
Keying to Pass charge per lock	KTP
Home Guard charge per lock	HG
Owner Guard charge per lock (includes Master Key)	BK
Owner Guard charge per lock	OG
No Cylinder (zero)	0

**LATCH & STRIKE SCREWS
STANDARD**

No. 7x3/4" Phillips Head Sheet Metal Screws for wood doors.



HILLCREST INTERIOR TRIM INCLUDED

HANDING	MODEL #	DESCRIPTION	PKG.	CASE WT	CASE QTY	6	N	1	2
^R/L	2810	Single Cylinder	Box	17	4	-	153.90	162.80	162.80
^R/L	2815	Single Cylinder (Dummy)	Box	17	4	-	153.90	162.80	162.80

Available with any knob and lever styles in Premiere Essentials Collection.

^Handing required when ordering a New Haven lever.



PARKSIDE INTERIOR TRIM INCLUDED

HANDING	MODEL #	DESCRIPTION	PKG.	CASE WT	CASE QTY	6	N	1	2
^R/L	2820	Single Cylinder	Box	17	4	-	153.90	162.80	-
^R/L	2825	Single Cylinder (Dummy)	Box	17	4	-	153.90	162.80	-

Available with any knob and lever styles in Premiere Essentials Collection.

^Handing required when ordering a New Haven lever.

GENERAL SPECIFICATIONS

PRODUCT CATEGORY	CYLINDER		STRIKES		FACEPLATES		DOOR HANDING	ADA	ANSI	UL	BORING REQUIREMENTS				DOOR THICKNESS		BACKSET	LATCH BOLT THROW	
	STANDARD	OPTIONAL	DEADBOLT	HANDLE	STANDARD	OPTIONAL					CROSS BORE		EDGE BORE	LATCH FACE	STANDARD	SPECIAL		DEADBOLT	HANDLE
											DEADBOLT	HANDLE							
Handlesets (Hillcrest, Parkside)	5 Pin Weslock Keyway	5 Pin Schlage Cor Kwikset Keyway	2-1/4" full lip and 1" x 2-1/4" no lip, Radius (Square Optional)	2-1/4" full lip, Radius (Square Optional)	1" x 2-1/4" Fixed Radius	1" x 2-1/4" Fixed Square or Drive-in	Specify handing for New Haven lever, for all others reversible for right or left-hand doors	N/A	A 156.2 Grade III	N/A	2-1/8" or 1-5/8"	2-1/8"	1"	1" x 2-1/4"	1-3/8" - 1-3/4"	N/A	Deadbolt Adjustable 2-3/8" or 2-3/4" Springlatch Non-Adjustable 2-3/8" or 2-3/4"	1"	1/2"

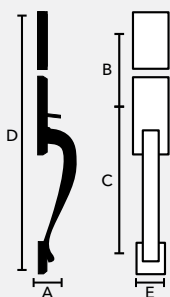

MODEL	A	B	C	D	E
Hillcrest	2-1/2"	*5-1/2"	8-7/16"	17"	2-7/8"
Parkside	2-1/2"	*5-1/2"	8-7/16"	17"	2-5/8"

*5-1/4" minimum

CLASSIFICATION KEY

- A - Projection from Door
- B - Center to Center
- C - Footscrew
- D - Full Length
- E - Width of Rose (Escutcheon Plate)



MERCY INTERIOR TRIM INCLUDED

HANDING	MODEL #	DESCRIPTION	PKG.	CASE WT	CASE QTY	6	N	1	2
^R/L	2830	Single Cylinder	Box	18	4	-	167.00	176.00	176.00
^R/L	2835	Single Cylinder (Dummy)	Box	18	4	-	167.00	176.00	176.00

Available with any knob and lever styles in Premiere Essentials Collection.

^Handing required when ordering a New Haven lever.



BAILEY INTERIOR TRIM INCLUDED

HANDING	MODEL #	DESCRIPTION	PKG.	CASE WT	CASE QTY	6	N	1	2
-	2840	Single Cylinder	Box	18	4	-	185.90	-	196.90
-	2845	Single Cylinder (Dummy)	Box	18	4	-	185.90	-	196.90

Available with Salem and Hudson Knob or New Haven lever.

Adjustable Foot Screw

GENERAL SPECIFICATIONS

PRODUCT CATEGORY	CYLINDER		STRIKES		FACEPLATES		DOOR HANDING	ADA	ANSI	UL	BORING REQUIREMENTS				DOOR THICKNESS		BACKSET	LATCH BOLT THROW	
	STANDARD	OPTIONAL	DEADBOLT	HANDLE	STANDARD	OPTIONAL					CROSS BORE		EDGE BORE	LATCH FACE	STANDARD	SPECIAL		DEADBOLT	HANDLE
											DEADBOLT	HANDLE							
Handlesets (Mercy)	5 Pin Weslock Keyway	5 Pin Schlage Cor Kwikset Keyway	2-1/4" full lip and 1" x 2-1/4" no lip, Radius (Square Optional)	2-1/4" full lip, Radius (Square Optional)	1" x 2-1/4" Fixed Radius	1" x 2-1/4" Fixed Square or Drive-in	Specify handing for New Haven lever, for all others reversible for right or left-hand doors	N/A	A 156.2 Grade III	N/A	2-1/8" or 1-5/8"	2-1/8"	1"	1" x 2-1/4"	1-3/8" - 1-3/4"	N/A	Deadbolt Adjustable 2-3/8" or 2-3/4" Springlatch Non-Adjustable 2-3/8" or 2-3/4"	1"	1/2"
Handlesets (Bailey)	5 Pin Weslock Keyway	5 Pin Schlage Cor Kwikset Keyway	2-1/4" full lip and 1" x 2-1/4" no lip, Radius (Square Optional)	2-1/4" full lip, Radius (Square Optional)	1" x 2-1/4" Fixed Radius	1" x 2-1/4" Fixed Square or Drive-in	Reversible for right or left-hand doors.	N/A	A 156.2 Grade II	N/A	2-1/8" or 1-5/8"	2-1/8"	1"	1" x 2-1/4"	1-3/8" - 2-1/4"	N/A	Deadbolt Adjustable 2-3/8" or 2-3/4" Springlatch Non-Adjustable 2-3/8" or 2-3/4"	1"	1/2"

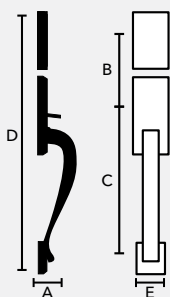

MODEL	A	B	C	D	E
Mercy	2-3/4"	*5-1/2"	8-7/16"	17-3/4"	2-5/8"
Bailey	2-1/4"	5-1/2"	8" - 9-1/2"	16-3/4"	2-1/2"

*5-1/4" minimum

CLASSIFICATION KEY

- A - Projection from Door
- B - Center to Center
- C - Footscrew
- D - Full Length
- E - Width of Rose (Escutcheon Plate)

HUDSON KNOB (G)



HANDING	MODEL #	DESCRIPTION	PKG.	CASE WT	CASE QTY	6	N	1	2
-	0200	Passage (Hall & Closet)	Box	35	30	21.80	21.80	25.10	25.10
-	0205	Dummy Knob	Box	13	30	10.10	10.10	11.70	11.70
-	0210	Privacy (Bed & Bath)	Box	36	30	23.30	23.30	26.40	26.40
-	0240	Keylock (Keyed Entry)	Box	40	30	27.60	27.60	30.90	30.90

SALEM KNOB (S)



HANDING	MODEL #	DESCRIPTION	PKG.	CASE WT	CASE QTY	6	N	1	2
-	0200	Passage (Hall & Closet)	Box	35	30	-	23.30	26.40	26.40
-	0205	Dummy Knob	Box	13	30	-	10.90	12.20	12.20
-	0210	Privacy (Bed & Bath)	Box	36	30	-	24.50	27.60	27.60
-	0240	Keylock (Keyed Entry)	Box	40	30	-	29.00	32.20	32.20

GENERAL SPECIFICATIONS

PRODUCT CATEGORY	CYLINDER		STRIKES		FACEPLATES		DOOR HANDING	ADA	ANSI	UL	BORING REQUIREMENTS			DOOR THICKNESS		BACKSET	LATCH BOLT THROW		
	STANDARD	OPTIONAL	DEADBOLT	HANDLE	STANDARD	OPTIONAL					CROSS BORE		EDGE BORE	LATCH FACE	STANDARD		SPECIAL	DEADBOLT	HANDLE
											DEADBOLT	HANDLE							
Knobs	5 Pin Weslock Keyway	5 Pin Schlage C or Kwikset Keyway	2-1/4" full lip, Radius (Square Optional)		1" x 2-1/4" Fixed Radius	1" x 2-1/4" Fixed Square or Drive-in	Reversible for right or left- hand doors	N/A	A 156.2 Grade III	N/A	2-1/8"	1"	1" x 2-1/4"	1-3/8" -2"	N/A	Adjustable 2-3/8" or 2-3/4"	1/2"		



MODEL	A	B	C	D	E
Hudson	2-7/8"	-	-	-	2-5/8"
Salem	2-5/8"	-	-	-	2-5/8"

CLASSIFICATION KEY

- A - Projection from Door
- B - Center to Center
- C - Footscrew
- D - Full Length
- E - Width of Rose (Escutcheon Plate)

NEW HAVEN NON-HANDED LEVERSETS (X)



HANDING	MODEL #	DESCRIPTION	PKG.	CASE WT	CASE QTY	6	N	1	2
-	0200	Passage (Hall & Closet)	Box	30	18	40.70	40.70	43.90	43.90
R/L	0205	Dummy Lever	Box	13	18	17.40	17.40	18.80	18.80
-	0210	Privacy (Bed & Bath)	Box	31	18	42.00	42.00	45.10	45.10
-	0240	Keylock (Keyed Entry)	Box	34	18	46.30	46.30	49.60	49.60

SOMERSET NON-HANDED LEVERSETS (V)



HANDING	MODEL #	DESCRIPTION	PKG.	CASE WT	CASE QTY	6	N	1	2
-	0200	Passage (Hall & Closet)	Box	30	18	-	33.10	38.10	-
-	0205	Dummy Lever	Box	13	18	-	15.10	17.70	-
-	0210	Privacy (Bed & Bath)	Box	31	18	-	34.40	39.20	-
-	0240	Keylock (Keyed Entry)	Box	34	18	-	39.20	44.10	-

GENERAL SPECIFICATIONS

PRODUCT CATEGORY	CYLINDER		STRIKES		FACEPLATES		DOOR HANDING	ADA	ANSI	UL	BORING REQUIREMENTS				DOOR THICKNESS		BACKSET	LATCH BOLT THROW	
	STANDARD	OPTIONAL	DEADBOLT	HANDLE	STANDARD	OPTIONAL					CROSS BORE		EDGE BORE	LATCH FACE	STANDARD	SPECIAL		DEADBOLT	HANDLE
											DEADBOLT	HANDLE							
Lever	5 Pin Weslock Keyway	5 Pin Schlage C or Kwikset Keyway	2-1/4" full lip, Radius (Square Optional)		1" x 2-1/4" Fixed Radius	1" x 2-1/4" Fixed Square or Drive-in	Specify handing for 205 New Haven levers, all other functions are reversible for right or left- hand doors	200 & 205 Functions Meet Sec. 4.13.9	A 156.2 Grade III	N/A	2-1/8"	1"	1" x 2-1/4"	1-3/8" -2"	N/A	Adjustable 2-3/8" or 2-3/4"	1/2"		



MODEL	A	B	C	D	E
New Haven	2-5/8"	-	-	-	2-5/8"
Somerset	2-5/8"	-	-	-	2-5/8"

CLASSIFICATION KEY

- A - Projection from Door
- B - Center to Center
- C - Footscrew
- D - Full Length
- E - Width of Rose (Escutcheon Plate)



DEADBOLTS

HANDING	MODEL #	DESCRIPTION	PKG.	CASE WT	CASE QTY	6	N	1	2
-	0271	Single Cylinder	Box	25	30	25.70	25.70	28.40	28.40
-	0267	Non-Cylinder	Box	13	30	17.90	17.90	19.90	19.90

GENERAL SPECIFICATIONS

PRODUCT CATEGORY	CYLINDER		STRIKES		FACEPLATES		DOOR HANDING	ADA	ANSI	UL	BORING REQUIREMENTS				DOOR THICKNESS		BACKSET	LATCH BOLT THROW	
	STANDARD	OPTIONAL	DEADBOLT	HANDLE	STANDARD	OPTIONAL					CROSS BORE		EDGE BORE	LATCH FACE	STANDARD	SPECIAL		DEADBOLT	HANDLE
											DEADBOLT	HANDLE							
Deadbolts	5 Pin Weslock Keyway	5 Pin Schlage C or Kwikset Keyway	2-1/4" full-lip and 1"x2-1/4" no lip, Radius (Square Optional)		1" x 2-1/4" Fixed Radius	1" x 2-1/4" Fixed Square or Drive-in	Reversible for right or left-hand doors	N/A	A 156.2 Grade III	N/A	2-1/8" or 1-5/8"	1"	1" x 2-1/4"	1-3/8" - 2"	N/A	Adjustable 2-3/8" or 2-3/4"	1"		



MODEL		A	B	C	D	E	
271	Single Cylinder	Interior	15/16"	-	-	-	2-1/2"
		Exterior	1"	-	-	-	2-1/2"
267	Non-Cylinder	Interior	15/16"	-	-	-	2-1/2"
		Exterior	-	-	-	-	-

CLASSIFICATION KEY

- A - Projection from Door
- B - Center to Center
- C - Footscrew
- D - Full Length
- E - Width of Rose (Escutcheon Plate)



HUDSON KNOB (G) / SINGLE CYLINDER DEADBOLT COMBO

HANDING	MODEL #	DESCRIPTION	PKG.	CASE WT	CASE QTY	6	N	1	2
-	2271	Keylock (Keyed Entry) and Single Cylinder Deadbolt Keyed Alike	Box	33	14	53.30	53.30	59.30	59.30



SALEM KNOB (S) / SINGLE CYLINDER DEADBOLT COMBO

HANDING	MODEL #	DESCRIPTION	PKG.	CASE WT	CASE QTY	6	N	1	2
-	2271	Keylock (Keyed Entry) and Single Cylinder Deadbolt Keyed Alike	Box	33	14	-	54.70	60.60	60.60



NEW HAVEN NON-HANDED LEVER (X) / SINGLE CYLINDER DEADBOLT COMBO

HANDING	MODEL #	DESCRIPTION	PKG.	CASE WT	CASE QTY	6	N	1	2
-	2271	Keylock (Keyed Entry) and Single Cylinder Deadbolt Keyed Alike	Box	30	10	72.00	72.00	78.00	78.00





GENERAL INFORMATION

PRODUCT DESCRIPTION CODES 2

COLLECTION PRICING & SPECIFICATIONS

ENTRY HANDLES 3-5

KNOBS 6

LEVERS 7

DEADBOLTS 8

Limited Twenty-Five Year Mechanical Warranty • Limited Five Year Finish Warranty

[THE FOLLOWING TABLES DESCRIBE SPECIFIC PRODUCT DESCRIPTION
CODES THAT ARE UNIQUE TO EACH POSITION IN THE SYSTEM.]

**HANDING
POSITION 1**

Position 1 is used for indicating right (R) or left (L) handing of levers and handlesets when applicable. Use a zero (0) when handing is not required.

**MODEL NUMBERS
POSITIONS 2,3,4,5**

Positions 2, 3, 4 & 5 are used to indicate the model and function of knobs, levers, deadbolts and handlesets. For those products with only three (3) digit model numbers, place a zero (0) in position 2.

- Knobsets/Leverets: See model numbers on pages 6 & 7
- Deadbolts: See model numbers on page 8
- Handlesets: See model numbers on page 3, 4 & 5

**EXTERIOR & INTERIOR KNOB & LEVER DESIGNS
POSITIONS 6 & 8**

KNOBBS	CODE
Mesa	4
LEVERS (NON-HANDED)	CODE
Uptown	8
Philtower	7
Brady	9
Utica	3

**EXTERIOR & INTERIOR FINISH CODES
POSITIONS 7 & 9**

FINISHES	U.S.	BMA	WESLOCK
Satin Nickel	15	619	N
Oil Rubbed Bronze	10B	613	1
Bright Chrome	26	625	6
Matte Black	19	622	2

**LATCH CODES - STANDARD
POSITIONS 10 & 11**

CODE	LATCH
FR	2-3/8" or 2-3/4", Adjustable Latch Radius Faceplate
DI	2-3/8" or 2-3/4", Adjustable Drive-in Latch (No Faceplate)
SL	2-3/8" or 2-3/4", Adjustable Latch Radius and Square Faceplates

**PACKAGING CODES
POSITION 12**

PACKAGING TYPES	CODE
Box Pack w/Phillips Head Wood Screws	2
Retail Pack	V

**KEYING CODES
POSITION 13**

KEYING TYPES	CODE
Keyed Alike	A
Keyed Different	D
Master Keying charge per lock	M
Grand Master Keying charge per lock	G
Keying to Pass charge per lock	KTP
Home Guard charge per lock	HG
Owner Guard charge per lock (includes Master Key)	BK
Owner Guard charge per lock	OG
No Cylinder (zero)	0

**LATCH & STRIKE SCREWS
STANDARD**

No. 7x3/4" Phillips Head Sheet Metal Screws for wood doors.



MAYO INTERIOR TRIM INCLUDED

HANDING	MODEL #	DESCRIPTION	PKG.	CASE WT	CASE QTY	6	N	1	2
-	2860	Single Cylinder	Box	17	4	-	193.00	202.00	202.00
-	2865	Single Cylinder (Dummy)	Box	17	4	-	193.00	202.00	202.00

Available with Mesa knob or Brady and Philtower lever styles.



BROOKSIDE INTERIOR TRIM INCLUDED

HANDING	MODEL #	DESCRIPTION	PKG.	CASE WT	CASE QTY	6	N	1	2
-	2880	Single Cylinder	Box	17	4	-	207.00	-	218.00
-	2885	Single Cylinder (Dummy)	Box	17	4	-	207.00	-	218.00

Available with Mesa knob or Philtower and Utica levers.

Adjustable Foot Screw

GENERAL SPECIFICATIONS

PRODUCT CATEGORY	CYLINDER		STRIKES		FACEPLATES		DOOR HANDING	ADA	ANSI	UL	BORING REQUIREMENTS				DOOR THICKNESS		BACKSET	LATCH BOLT THROW	
	STANDARD	OPTIONAL	DEADBOLT	HANDLE	STANDARD	OPTIONAL					CROSS BORE		EDGE BORE	LATCH FACE	STANDARD	SPECIAL		DEADBOLT	HANDLE
											DEADBOLT	HANDLE							
Handlesets (Mayo)	5 Pin Weslock Keyway	5 Pin Schlage Cor Kwikset Keyway	2-1/4" full lip and 1" x 2-1/4" no lip, Radius	2-1/4" full lip, Radius	1" x 2-1/4" Fixed Radius	Fixed Square or Drive-In	N/A	N/A	A 156.2 Grade III	N/A	2-1/8" or 1-5/8"	2-1/8"	1"	1" x 2-1/4"	1-3/8" - 1-3/4"	N/A	Deadbolt Adjustable 2-3/8" or 2-3/4" Springlatch Adjustable 2-3/8" or 2-3/4"	1"	1/2"
Handlesets (Brookside)	5 Pin Weslock Keyway	5 Pin Schlage Cor Kwikset Keyway	2-1/4" full lip and 1" x 2-1/4" no lip, Radius	2-1/4" full lip, Radius	1" x 2-1/4" Fixed Radius	Fixed Square or Drive-In	N/A	N/A	A 156.2 Grade II	N/A	2-1/8" or 1-5/8"	2-1/8"	1"	1" x 2-1/4"	1-3/8" - 2-1/4"	N/A	Deadbolt Adjustable 2-3/8" or 2-3/4" Springlatch Adjustable 2-3/8" or 2-3/4"	1"	1/2"

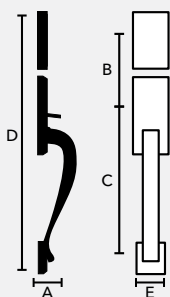

MODEL	A	B	C	D	E
Mayo	2-3/4"	*5-1/2"	8-7/16"	17-3/4"	2-5/8"
Brookside	2-1/4"	5-1/2"	8"-9-1/4"	16-3/4"	2-1/2"

*5-1/4" minimum

CLASSIFICATION KEY

- A - Projection from Door
- B - Center to Center
- C - Footscrew
- D - Full Length
- E - Width of Rose (Escutcheon Plate)



Adjustable Foot Screw

LEIGHTON INTERIOR TRIM INCLUDED

HANDING	MODEL #	DESCRIPTION	PKG.	CASE WT	CASE QTY	6	N	1	2
-	2870	Single Cylinder	Box	26	4	-	302.00	328.00	328.00
-	2875	Single Cylinder (Dummy)	Box	21	4	-	302.00	328.00	328.00

Available with Mesa knob and Philtower or Utica levers.



Adjustable Foot Screw

XANTHIS INTERIOR TRIM INCLUDED

HANDING	MODEL #	DESCRIPTION	PKG.	CASE WT	CASE QTY	6	N	1	2
-	2890	Single Cylinder	Box	30	4	-	365.00	385.00	385.00
-	2895	Single Cylinder (Dummy)	Box	25	4	-	365.00	385.00	385.00

Available with Mesa knob and Philtower or Utica levers.

GENERAL SPECIFICATIONS

PRODUCT CATEGORY	CYLINDER		STRIKES		FACEPLATES		DOOR HANDING	ADA	ANSI	UL	BORING REQUIREMENTS				DOOR THICKNESS		BACKSET	LATCH BOLT THROW	
	STANDARD	OPTIONAL	DEADBOLT	HANDLE	STANDARD	OPTIONAL					CROSS BORE		EDGE BORE	LATCH FACE	STANDARD	SPECIAL		DEADBOLT	HANDLE
											DEADBOLT	HANDLE							
Handlesets (Leighton, Xanthis)	5 Pin Weslock Keyway	5 Pin Schlage Cor Kwikset Keyway	2-1/4" full lip and 1" x 2-1/4" no lip, Radius and Square	2-1/4" full lip, Radius and Square	1" x 2-1/4" Removable Radius or Square	Drive-In	N/A	N/A	A156.2 Grade II	N/A	2-1/8" or 1-5/8"	2-1/8"	1"	1" x 2-1/4"	1-3/8" - 2-1/4"	N/A	Deadbolt Adjustable 2-3/8" or 2-3/4" Springlatch Adjustable 2-3/8" or 2-3/4"	1"	1/2"

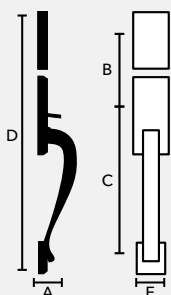

MODEL		A	B	C	D	E
Leighton	Exterior	2-1/4"	5-1/2"	8"-9-1/2"	18-3/8"	2-3/4"
	Interior	2-1/4"	5-1/2"	-	11"	2-3/4"
Xanthis	Exterior	2-1/4"	5-1/2"	7-3/4"-9-1/4"	17-3/8"	2-1/2"
	Interior	2-1/4"	5-1/2"	-	10-5/16"	2-1/2"

CLASSIFICATION KEY

- A - Projection from Door
- B - Center to Center
- C - Footscrew
- D - Full Length
- E - Width of Rose (Escutcheon Plate)



ADDY INTERIOR TRIM INCLUDED

HANDING	MODEL #	DESCRIPTION	PKG.	CASE WT	CASE QTY	6	N	1	2
-	6621	Single Cylinder Deadbolt Passage	Box	20	4	-	-	242.00	242.00
-	6625	Dummy Handle (all parts rigid)	Box	16	4	-	-	242.00	242.00

Available with Mesa knob and Philtower or Utica levers.

GENERAL SPECIFICATIONS

PRODUCT CATEGORY	CYLINDER		STRIKES		FACEPLATES		DOOR HANDING	ADA	ANSI	UL	BORING REQUIREMENTS				DOOR THICKNESS		BACKSET	LATCH BOLT THROW	
	STANDARD	OPTIONAL	DEADBOLT	HANDLE	STANDARD	OPTIONAL					CROSS BORE		EDGE BORE	LATCH FACE	STANDARD	SPECIAL		DEADBOLT	HANDLE
											DEADBOLT	HANDLE							
Handlesets (Addy)	5 Pin Weslock Keyway	5 Pin Schlage C or Kwikset Keyway	2-1/4" full lip and 1" x 2-1/4" no lip, Radius and Square	2-1/4" full lip, Radius and Square	1" x 2-1/4" Removable Radius or Square	Drive-In	N/A	N/A	A 156.2 Grade II	N/A	2-1/8" or 1-5/8"	2-1/8"	1"	1" x 2-1/4"	1-3/8" - 2-1/4"	N/A	Deadbolt Adjustable 2-3/8" or 2-3/4" Springlatch Adjustable 2-3/8" or 2-3/4"	1"	1/2"

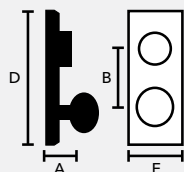

MODEL	A	B	C	D	E
Addy	2"	5-1/2"	-	11"	2-13/16"

CLASSIFICATION KEY

- A - Projection from Door
- B - Center to Center
- C - Footscrew
- D - Full Length
- E - Width of Rose (Escutcheon Plate)

NEW



MESA KNOB (4)

HANDING	MODEL #	DESCRIPTION	PKG.	CASE WT	CASE QTY	6	N	1	2
-	0700	Passage (Hall & Closet)	Box	30	15	-	54.00	-	59.00
-	0705	Dummy Knob	Box	15	15	-	27.00	-	30.00
-	0710	Privacy (Bed & Bath)	Box	33	15	-	60.00	-	65.00
-	N/A	Keylock (Keyed Entry)	-	-	-	-	-	-	-

GENERAL SPECIFICATIONS

PRODUCT CATEGORY	CYLINDER		STRIKES		FACEPLATES		DOOR HANDING	ADA	ANSI	UL	BORING REQUIREMENTS				DOOR THICKNESS		BACKSET	LATCH BOLT THROW	
	STANDARD	OPTIONAL	DEADBOLT	HANDLE	STANDARD	OPTIONAL					CROSS BORE		EDGE BORE	LATCH FACE	STANDARD	SPECIAL		DEADBOLT	HANDLE
											DEADBOLT	HANDLE							
Knobs (Mesa)	N/A	N/A	2-1/4" Full Lip, Radius (Square Optional)		1" x 2-1/4" Fixed Radius	Fixed Square or Drive-In	Non-Handed	N/A	A 156.2 Grade III	N/A	2-1/8"		1"	1" x 2-1/4"	1-3/8" - 1-3/4"	N/A	Adjustable 2-3/8" or 2-3/4"	1/2" throw	

CLASSIFICATION KEY

- A - Projection from Door
- B - Center to Center
- C - Footscrew
- D - Full Length
- E - Width of Rose (Escutcheon Plate)



MODEL	A	B	C	D	E
Mesa	2-9/16"				2-1/2"

UPTOWN NON-HANDED LEVERSETS (8)

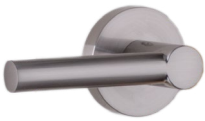

HANDING	MODEL #	DESCRIPTION	PKG.	CASE WT	CASE QTY	6	N	1	2
-	0500	Passage (Hall & Closet)	Box	45	18	54.00	54.00	-	-
-	0505	Dummy Lever	Box	18	18	27.00	27.00	-	-
-	0510	Privacy (Bed & Bath)	Box	46	18	60.00	60.00	-	-
-	N/A	Keylock (Keyed Entry)	-	-	-	-	-	-	-

PHILTOWER NON-HANDED LEVERSETS (7)

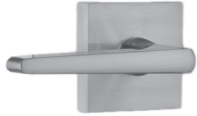

HANDING	MODEL #	DESCRIPTION	PKG.	CASE WT	CASE QTY	6	N	1	2
-	0700	Passage (Hall & Closet)	Box	42	18	54.00	54.00	59.00	59.00
-	0705	Dummy Lever	Box	19	18	27.00	27.00	30.00	30.00
-	0710	Privacy (Bed & Bath)	Box	43	18	60.00	60.00	65.00	65.00
-	N/A	Keylock (Keyed Entry)	-	-	-	-	-	-	-

BRADY NON-HANDED LEVERSETS (9)



HANDING	MODEL #	DESCRIPTION	PKG.	CASE WT	CASE QTY	6	N	1	2
-	0700	Passage (Hall & Closet)	Box	47	18	-	54.00	59.00	59.00
-	0705	Dummy Lever	Box	21	18	-	27.00	30.00	30.00
-	0710	Privacy (Bed & Bath)	Box	48	18	-	60.00	65.00	65.00
-	N/A	Keylock (Keyed Entry)	-	-	-	-	-	-	-

NEW

UTICA NON-HANDED LEVERSETS (3)



HANDING	MODEL #	DESCRIPTION	PKG.	CASE WT	CASE QTY	6	N	1	2
-	0700	Passage (Hall & Closet)	Box	41	18	-	54.00	59.00	59.00
-	0705	Dummy Lever	Box	18	18	-	27.00	30.00	30.00
-	0710	Privacy (Bed & Bath)	Box	43	18	-	60.00	65.00	65.00
-	N/A	Keylock (Keyed Entry)	-	-	-	-	-	-	-

GENERAL SPECIFICATIONS

PRODUCT CATEGORY	CYLINDER		STRIKES		FACEPLATES		DOOR HANDING	ADA	ANSI	UL	BORING REQUIREMENTS			DOOR THICKNESS		BACKSET	LATCH BOLT THROW		
	STANDARD	OPTIONAL	DEADBOLT	HANDLE	STANDARD	OPTIONAL					CROSS BORE		EDGE BORE	LATCH FACE	STANDARD		SPECIAL	DEADBOLT	HANDLE
											DEADBOLT	HANDLE							
Lever (Uptown, Philtower, Brady)	N/A	N/A	2-1/4" Full Lip, Radius (Square Optional)		1" x 2-1/4" Fixed Radius	Fixed Square or Drive-In	Non-Handed	Yes	A 156.2 Grade III	N/A	2-1/8"	1"	1" x 2-1/4"	1-3/8" - 1-3/4"	N/A	Adjustable 2-3/8" or 2-3/4"	1/2" throw		
Lever (Utica)	N/A	N/A	2-1/4" Full Lip, Radius (Square Optional)		1" x 2-1/4" Fixed Radius	Fixed Square or Drive-In	Non-Handed	Yes	A 156.2 Grade II	N/A	2-1/8"	1"	1" x 2-1/4"	1-3/8" - 2-1/4"	N/A	Adjustable 2-3/8" or 2-3/4"	1/2" throw		



MODEL	A	B	C	D	E
Uptown	2-1/2"	-	-	-	2-9/16"
Philtower	2-1/2"	-	-	-	2-9/16"
Brady	2-1/2"	-	-	-	2-9/16"
Utica	2-7/16"	-	-	-	2-1/2"

CLASSIFICATION KEY

- A - Projection from Door
- B - Center to Center
- C - Footscrew
- D - Full Length
- E - Width of Rose (Escutcheon Plate)

ROUND DEADBOLT



HANDING	MODEL #	DESCRIPTION	PKG.	CASE WT	CASE QTY	6	N	1	2
-	0571	Single Cylinder	Box	24	18	63.00	63.00	-	-

SQUARE DEADBOLT



HANDING	MODEL #	DESCRIPTION	PKG.	CASE WT	CASE QTY	6	N	1	2
-	0771	Single Cylinder	Box	25	18	63.00	63.00	67.00	67.00

GENERAL SPECIFICATIONS

PRODUCT CATEGORY	CYLINDER		STRIKES		FACEPLATES		DOOR HANDING	ADA	ANSI	UL	BORING REQUIREMENTS			DOOR THICKNESS		BACKSET	LATCH BOLT THROW		
	STANDARD	OPTIONAL	DEADBOLT	HANDLE	STANDARD	OPTIONAL					CROSS BORE		EDGE BORE	LATCH FACE	STANDARD		SPECIAL	DEADBOLT	HANDLE
											DEADBOLT	HANDLE							
Deadbolts	5 Pin Weslock Keyway	5 Pin Schlage C or Kwikset Keyway	2-1/4" full lip and 1"x2-1/4" no lip, Radius (Square Optional)		1" x 2-1/4" Fixed Radius	Fixed Square or Drive-In	N/A	Yes	A 156.2 Grade III	N/A	2-1/8" or 1-5/8"	1"	1" x 2-1/4"	1-3/8" - 1-3/4"	N/A	Adjustable 2-3/8" or 2-3/4"	1" throw		



MODEL			A	B	C	D	E
0571	Single Cylinder	Interior	1-1/4"	-	-	-	2-1/2"
		Exterior	3/4"	-	-	-	2-1/2"
0771	Single Cylinder	Interior	1-1/4"	-	-	-	2-1/2"
		Exterior	3/4"	-	-	-	2-1/2"

CLASSIFICATION KEY

- A - Projection from Door
- B - Center to Center
- C - Footscrew
- D - Full Length
- E - Width of Rose (Escutcheon Plate)





GENERAL INFORMATION

PRODUCT DESCRIPTION CODES	2
---------------------------	---

COLLECTION PRICING & SPECIFICATIONS

PREMIERE ESSENTIALS LEVER	3
PREMIERE ESSENTIALS DEADBOLTS	3
TRANSITIONAL KNOB	4
TRANSITIONAL LEVER	4
TRANSITIONAL DEADBOLTS	4

Limited Twenty-Five Year Mechanical Warranty • Limited Five Year Finish Warranty

THE FOLLOWING TABLES DESCRIBE SPECIFIC PRODUCT DESCRIPTION CODES THAT ARE UNIQUE TO EACH POSITION IN THE SYSTEM.

HANDING POSITION 1

Position 1 is used for indicating right (R) or left (L) handing of levers and handlesets when applicable. Use a zero (0) when handing is not required.

MODEL NUMBERS POSITIONS 2,3,4,5

Positions 2, 3, 4 & 5 are used to indicate the model and function of knobs, levers, deadbolts and handlesets. For those products with only three (3) digit model numbers, place a zero (0) in position 2.

- Knobsets/Leverets: See model numbers on pages 3 & 4
- Deadbolts: See model numbers on pages 3 & 4

EXTERIOR & INTERIOR KNOB & LEVER DESIGNS POSITIONS 6 & 8

KNOBS	CODE
Mesa	4
LEVERS (NON-HANDED)	CODE
Philtower	7
Bristol	W

EXTERIOR & INTERIOR FINISH CODES POSITIONS 7 & 9

FINISHES	U.S.	BMA	WESLOCK
Satin Nickel	15	619	N
Oil Rubbed Bronze	10B	613	1
Matte Black	19	622	2

LATCH CODES - STANDARD POSITIONS 10 & 11

CODE	LATCH
FR	2-3/8" or 2-3/4", Adjustable Latch Radius Faceplate
DI	2-3/8" or 2-3/4", Adjustable Drive-in Latch (No Faceplate)
SL	2-3/8" or 2-3/4", Adjustable Latch, Square and Radius Faceplate

PACKAGING CODES POSITION 12

PACKAGING TYPES	CODE
Box Pack w/Phillips Head Wood Screws	2

KEYING CODES POSITION 13

KEYING TYPES	CODE
Keyed Alike	A
Keyed Different	D
Master Keying charge per lock	M
Grand Master Keying charge per lock	G
Keying to Pass charge per lock	KTP
Home Guard charge per lock	HG
Owner Guard charge per lock (includes Master Key)	BK
Owner Guard charge per lock	OG
No Cylinder (zero)	0

LATCH & STRIKE SCREWS STANDARD

No. 7x3/4" Phillips Head Sheet Metal Screws for wood doors.

BRISTOL NON-HANDED LEVERSETS (W)



HANDING	MODEL #	DESCRIPTION	PKG.	CASE WT	CASE QTY	6	N	1	2
-	0200	Passage (Hall & Closet)	Box	30	18	-	33.10	-	-
-	0205	Dummy Lever	Box	13	18	-	15.10	-	-
-	0210	Privacy (Bed & Bath) Turn Button	Box	31	18	-	36.00	-	-
-	0310	Privacy (Bed & Bath) Push Button	Box	31	18	-	36.00	-	-
-	0240	Keylock (Keyed Entry)	Box	34	18	-	39.20	-	-

DEADBOLTS



HANDING	MODEL #	DESCRIPTION	PKG.	CASE WT	CASE QTY	6	N	1	2
-	0871	Single Cylinder	Box	25	30	-	30.70	-	-
-	0867	Non-Cylinder	Box	13	30	-	22.90	-	-

GENERAL SPECIFICATIONS

PRODUCT CATEGORY	CYLINDER		STRIKES		FACEPLATES		DOOR HANDING	ADA	ANSI	UL	BORING REQUIREMENTS			DOOR THICKNESS		BACKSET	LATCH BOLT THROW		
	STANDARD	OPTIONAL	DEADBOLT	HANDLE	STANDARD	OPTIONAL					CROSS BORE		EDGE BORE	LATCH FACE	STANDARD		SPECIAL	DEADBOLT	HANDLE
											DEADBOLT	HANDLE							
Lever	5 Pin Kwikset Keyway	5 Pin Schlage C Keyway	2-1/4" Full Lip, Radius (Square Optional)		1" x 2-1/4" Fixed Radius	1" x 2-1/4" Fixed Radius	Reversible for right or left-hand doors	Yes	A 156.2 Grade II	20 Minute	2-1/8"	1"	1" x 2-1/4"	1-3/8" - 2"	N/A	Adjustable 2-3/8" or 2-3/4"	1/2" throw		
Deadbolts (871/867)	5 Pin Weslock Keyway	5 Pin Schlage Cor Kwikset Keyway	2-1/4" Full Lip and 1"x2-1/4" No Lip, Radius (Square Optional)		1" x 2-1/4" Fixed Radius	1" x 2-1/4" Fixed Square	Reversible for right or left-hand doors	Yes	A 156.2 Grade II	20 Minute	2-1/8" or 1-5/8"	1"	1" x 2-1/4"	1-3/8" - 2"	N/A	Adjustable 2-3/8" or 2-3/4"	1" throw		



MODEL	A	B	C	D	E
Bristol	2-7/16"	-	-	-	2-9/16"



MODEL		A	B	C	D	E
0871	Single Cylinder	Interior	15/16"	-	-	2-1/2"
		Exterior	1"	-	-	2-1/2"
0867	Non-Cylinder	Interior	15/16"	-	-	2-1/2"
		Exterior	1"	-	-	-

CLASSIFICATION KEY

- A - Projection from Door
- B - Center to Center
- C - Footscrew
- D - Full Length
- E - Width of Rose (Escutcheon Plate)

PHILTOWER NON-HANDED LEVERSETS (7)

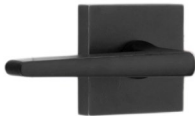

HANDING	MODEL #	DESCRIPTION	PKG.	CASE WT	CASE QTY	6	N	1	2
-	U700	Passage (Hall & Closet)	Box	41	18	-	-	64.00	64.00
-	U706	Dummy Lever Passage Set	Box	34	18	-	-	60.00	60.00
-	U710	Privacy (Bed & Bath)	Box	43	18	-	-	70.00	70.00
-	N/A	Keylock (Keyed Entry)	-	-	-	-	-	-	-

MESA KNOB (4)



HANDING	MODEL #	DESCRIPTION	PKG.	CASE WT	CASE QTY	6	N	1	2
-	U700	Passage (Hall & Closet)	Box	40	15	-	-	69.00	69.00
-	U706	Dummy Knob Passage Set	Box	33	15	-	-	65.00	65.00
-	U710	Privacy (Bed & Bath)	Box	47	15	-	-	75.00	75.00
-	N/A	Keylock (Keyed Entry)	-	-	-	-	-	-	-

SQUARE DEADBOLT



HANDING	MODEL #	DESCRIPTION	PKG.	CASE WT	CASE QTY	6	N	1	2
-	U771	Single Cylinder	Box	27	18	-	-	72.00	72.00
-	U767	Non-Cylinder	Box	-	18	-	-	44.00	44.00

GENERAL SPECIFICATIONS

PRODUCT CATEGORY	CYLINDER		STRIKES		FACEPLATES		DOOR HANDING	ADA	ANSI	UL	BORING REQUIREMENTS				DOOR THICKNESS		BACKSET	LATCH BOLT THROW	
	STANDARD	OPTIONAL	DEADBOLT	HANDLE	STANDARD	OPTIONAL					CROSS BORE		EDGE BORE	LATCH FACE	STANDARD	SPECIAL		DEADBOLT	HANDLE
											DEADBOLT	HANDLE							
Lever	N/A	N/A	2-1/4" Full Lip, Radius and Square		1" x 2-1/4" Removable Radius & Square	N/A	Reversible for right or left-hand doors	Yes	A 156.2 Grade II	20 Minute	2-1/8"	1"	1" x 2-1/4"	1-3/8" - 2-1/4"	N/A	Adjustable 2-3/8" or 2-3/4"	1/2" Throw		
Knob	N/A	N/A	2-1/4" Full Lip, Radius and Square		1" x 2-1/4" Removable Radius & Square	N/A	Reversible for right or left-hand doors	No	A 156.2 Grade II	20 Minute	2-1/8"	1"	1" x 2-1/4"	1-3/8" - 2-1/4"	N/A	Adjustable 2-3/8" or 2-3/4"	1/2" Throw		
Deadbolts	5 Pin Weslock Keyway	5 Pin Schlage Cor Kwikset Keyway	2-1/4" Full Lip and 1"x2-1/4" no lip, Radius and Square		1" x 2-1/4" Removable Radius & Square	N/A	Reversible for right or left-hand doors	Yes	A 156.2 Grade II	20 Minute	2-1/8" or 1-5/8"	1"	1" x 2-1/4"	1-3/8" - 2-1/4"	N/A	Adjustable 2-3/8" or 2-3/4"	1" Throw		



MODEL	A	B	C	D	E
Philtower	2-7/16"	-	-	-	2-1/2"



MODEL	A	B	C	D	E
Mesa	2-7/16"	-	-	-	2-1/2"



MODEL		A	B	C	D	E
U771	Single Cylinder	Interior	1-1/4"	-	-	2-1/2"
	Exterior	3/4"	-	-	-	2-1/2"
U767	Non-Cylinder	Interior	1-1/4"	-	-	2-1/2"
	Exterior	-	-	-	-	-

CLASSIFICATION KEY

- A - Projection from Door
- B - Center to Center
- C - Footscrew
- D - Full Length
- E - Width of Rose (Escutcheon Plate)



GENERAL INFORMATION

HOW TO READ / WRITE AN ORDER	2
PRODUCT DESCRIPTION CODES	3

COLLECTION PRICING & SPECIFICATIONS

BATH HARDWARE	4-5
---------------	-----

Limited One Year Warranty

TERMS & CONDITIONS OF SALE

The Terms & Conditions of Sale for Weslock's® Bath hardware contained herein shall be the same as those for Weslock® door hardware (as identified on pages 2 and 3 of general information section of this price book) with the following freight modifications.

FREIGHT

The Company will be responsible for the payment of freight charges on all shipments of \$500 net or more by the carrier of the Company's selection to all points in the continental United States. Freight charges will not be paid for by the Company for shipments of less than \$500 net. When combined with Weslock® door lock purchases, freight will be paid for by the Company for shipments greater than \$1,250 net.

HOW TO READ/WRITE A BATH HARDWARE ORDER

WESLOCK's® computer program requires assigning a unique 9 digit part number to each specific item being ordered. Each of the 9 digit positions describes the specific attributes of the product. The information provided by each digit's position is illustrated as follows:

HOW TO READ A BATH HARDWARE ORDER
(HOW TO READ A 9 DIGIT PART NUMBER.)

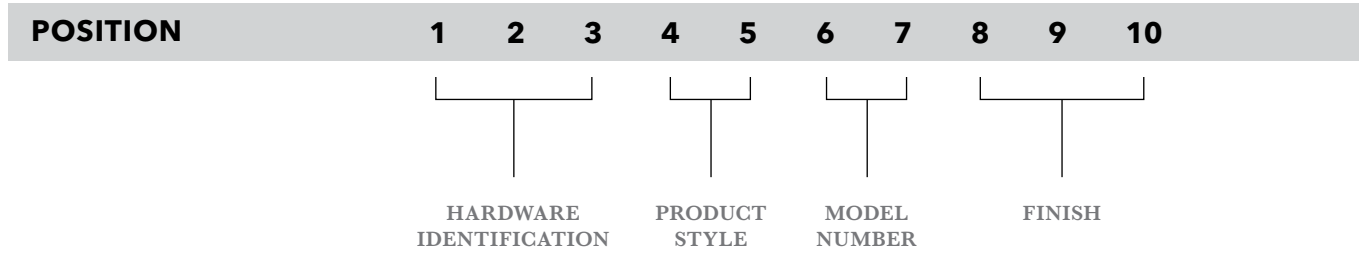

HOW TO WRITE A BATH HARDWARE ORDER

(The following ordering example shows the 9 digit product code as it will appear on all acknowledgments.)

POSITION	1-3	4-5	6-7	8-10
QUANTITY	IDENTIFICATION	PRODUCT STYLE	MODEL NUMBER	FINISH
24	WH-	74	01	-SN

[THE FOLLOWING TABLES DESCRIBE SPECIFIC PRODUCT DESCRIPTION
CODES THAT ARE UNIQUE TO EACH POSITION IN THE SYSTEM.]

**IDENTIFICATION
POSITIONS 1 - 3**

Positions 1-3 for all Weslock® hardware items require the following: WH-

**PRODUCT STYLE
POSITIONS 4 & 5**

Positions 4-5 are used to indicate product style.

BATH HARDWARE	
Florence Series	74
Canton Series	79

**PRODUCT DESCRIPTION CODES
POSITIONS 6 - 7**

Position 6 - 7 are used to indicate the model and function of the Weslock® hardware items.

BATH HARDWARE	CODE
Robe Hook	01
Euro Tissue	06
Standard Tissue	07
Towel Bar - 18"	18
Towel Bar - 24"	24
Towel Ring	30

**FINISH CODES
POSITIONS 8 - 9**

The first position of the finish code is position 8 which is always designated by the letter X. Position 9 identifies the finish.

FINISHES	U.S.	BMA	WESLOCK
Bright Chrome	26	625	CH
Satin Nickel	15	619	SN
Oil Rubbed Bronze	10B	613	ORB
Black	19	622	BLK

PACKAGING

Reference the general specifications pages 4 for packaging information.

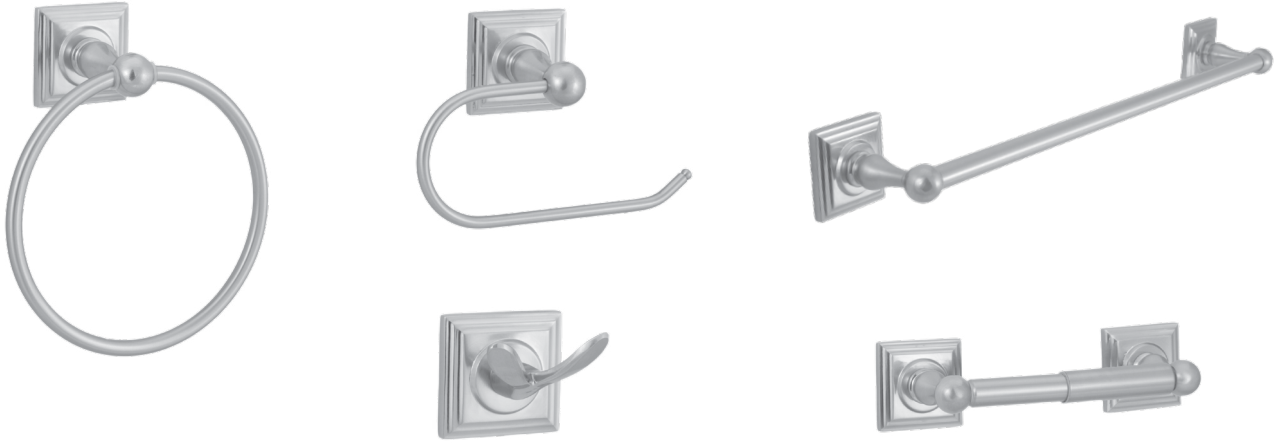

FLORENCE 7400 SERIES

Matte Black finish available Summer 2022

NEW

MODEL #	DESCRIPTION	PACKAGING	CASE WT	CASE QTY	6	N	1	2
WH-7401	Robe Hook	Box	13	100	-	11.60	12.50	12.50
WH-7406	Euro Tissue	Box	12	50	-	25.20	26.20	26.20
WH-7407	Standard Tissue	Box	15	50	-	25.20	26.20	-
WH-7418	18" Towel Bar	Box	11	25	-	31.20	32.50	-
WH-7424	24" Towel Bar	Box	12	25	-	32.80	33.90	33.90
WH-7430	Towel Ring	Box	11	50	-	23.30	23.90	23.90

GENERAL SPECIFICATIONS

SERIES	PART NUMBER	GENERAL DIMENSIONS RANGE					PKG PER CASE	CASE WEIGHT
		BACKPLATE HEIGHT	BACKPLATE WIDTH	PROJECTION	OVERALL LENGTH	CENTER TO CENTER	BOX PACK	
FLORENCE 7400 SERIES								
Robe Hook	7401	1/2"	2 1/4"	2 1/4"	2 1/4"	N/A	100	13
Euro Tissue	7406	1/2"	2 1/4"	3"	6 1/2"	N/A	50	12
Standard Tissue	7407	1/2"	2 1/4"	3"	8 5/8"	6 1/2"	50	15
18" Towel Bar	7418	1/2"	2 1/4"	3"	19 5/8"	17 1/2"	25	11
24" Towel Bar	7424	1/2"	2 1/4"	3"	25 5/8"	23 1/2"	25	12
Towel Ring	7430	1/2"	2 1/4"	3"	6 1/8"	N/A	50	11



CANTON 7900 SERIES

Matte Black finish available Summer 2022

NEW

MODEL #	DESCRIPTION	PACKAGING	CASE WT	CASE QTY	6	N	1	2
WH-7901	Robe Hook	Box	14	100	12.10	12.60	13.60	13.60
WH-7906	Euro Tissue	Box	15	50	-	26.20	27.30	27.30
WH-7907	Standard Tissue	Box	18	50	25.70	26.20	27.30	-
WH-7918	18" Towel Bar	Box	12	25	32.30	32.80	34.00	-
WH-7924	24" Towel Bar	Box	12	25	33.80	34.30	35.40	35.40
WH-7930	Towel Ring	Box	12	50	23.90	24.40	25.00	25.00

GENERAL SPECIFICATIONS

SERIES	PART NUMBER	GENERAL DIMENSIONS RANGE					PKG PER CASE	CASE WEIGHT
		BACKPLATE HEIGHT	BACKPLATE WIDTH	PROJECTION	OVERALL LENGTH	CENTER TO CENTER	BOX PACK	
CANTON 7900 SERIES								
Robe Hook	7901	3/4"	2 3/4"	2 5/8"	2 3/4"	N/A	100	14
Euro Tissue	7906	3/4"	2 3/4"	3 3/8"	6 1/2"	N/A	50	15
Standard Tissue	7907	3/4"	2 3/4"	3 3/8"	9 1/8"	6 1/2"	50	18
18" Towel Bar	7918	3/4"	2 3/4"	3 3/8"	20 1/8"	17 1/2"	25	12
24" Towel Bar	7924	3/4"	2 3/4"	3 3/8"	26 1/8"	23 1/2"	25	12
Towel Ring	7930	3/4"	2 3/4"	3 3/8"	6 1/8"	N/A	50	12



BUILDERS HARDWARE

HOW TO READ / WRITE A HINGE ORDER	2
HINGE BOX PRICING	2
SLIDING POCKET DOOR LOCKS	3

PARTS & ACCESSORIES

REPLACEMENT CYLINDERS	4
INSTALLATION TOOLS	4
KEYING KITS	5
EXTRA THICK & THIN DOOR KITS	5

LATCHES & STRIKES

STRIKES & FACEPLATES	6
LATCHES	7-8

MERCHANDISING

LITERATURE	9
DISPLAY MOUNTS / BOARDS	9-10

HOW TO READ/WRITE A HINGE ORDER

Weslock's® computer program requires assigning a unique 11 digit part number to each specific item being ordered. Each of the 11 digit positions describes the specific attributes of the product. The information provided by each digit's position is illustrated as follows:

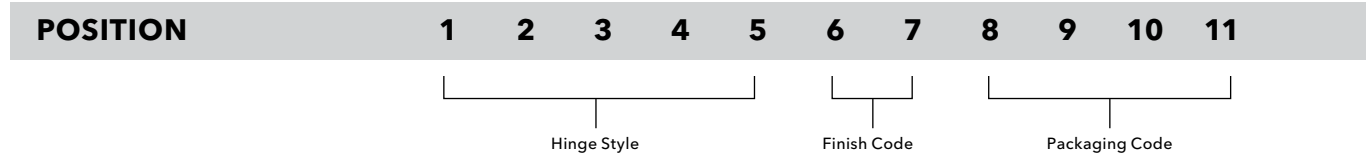

HOW TO WRITE A WESLOCK® HINGE ORDER

(The following ordering example shows the 11 digit product code as it will appear on all acknowledgements.)

POSITION	1-5	6-7	8-11
QUANTITY	Hinge Style	Finish Code	Packaging Code
30	70100 (3-1/2" X 3-1/2" hinge)	X1 (Oil Rubbed Bronze)	-002 (Box Pack - 1 pair)

The following tables describe specific product description codes that are unique to each position in the system.

HINGE STYLE POSITIONS 1-5

Positions 1-5 are used to indicate the product style.

3-1/2" x 3-1/2" size	5/8" radius	70100
----------------------	-------------	-------

FINISH CODES POSITIONS 6-7

The first position of the finish code is position 6 which is always designated by the letter X. Position 7 identifies the finish.

FINISHES	U.S.	BMA	WESLOCK
Satin Nickel	15	619	N
Oil Rubbed Bronze	10B	613	1
Black	19	622	2

PACKAGING CODES POSITIONS 8-11

Box Pack (1 pair, 30 pair/Master Carton)	-002
--	------

SCREWS

3-1/2" x 3-1/2" size hinge:
Box Pack: Includes 14 wood screws (3/4" length).



**BUILDERS HARDWARE
HINGES - ROUND**

WESLOCK® FEATURES & INFORMATION: HINGES

- Solid steel decorative hinges
- Includes 3/4" screws (7 screws per hinge) for 1-1/2" hinge
- Available in three (3) finishes.

3-1/2" X 3-1/2" HINGE – 5/8" RADIUS

PART NUMBER	FINISH CODE	PACKAGE CODE	LIST PRICE
Box			Per Pair
70100	N, 1, 2	-002	12.10

627



677



SLIDING POCKET DOOR LOCKS - ROUND

MODEL #	DESCRIPTION	CASE WT.	CASE QTY.	PRICE FINISH N,1,2
0627	Round - Passage (No locking)	29lbs	50	35.00
0677	Round - Privacy Lock	32lbs	50	40.00

* Available in 2-3/8" backset only.
 * Requires 2-1/8" cross bore.

727

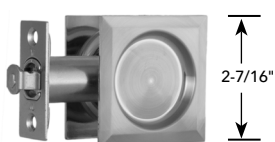

777



SLIDING POCKET DOOR LOCKS - SQUARE WITH ROUND

MODEL #	DESCRIPTION	CASE WT.	CASE QTY.	PRICE FINISH N,2
0727	Square w/ Round - Passage (No Locking)	19lbs	50	35.00
0777	Square w/ Round - Privacy Lock	20lbs	50	40.00

* Available in 2-3/8" backset only.
 * Requires 2-1/8" cross bore.

527

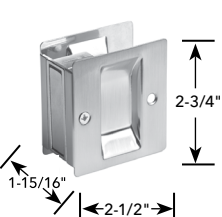

577

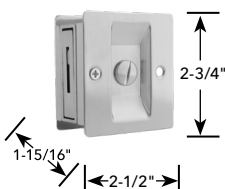

SLIDING POCKET DOOR LOCKS - RECTANGULAR

MODEL #	DESCRIPTION	CASE WT.	CASE QTY.	PRICE FINISH N,1
0527	Rectangular - Passage (No locking)	19lbs	50	23.00
0577	Rectangular - Privacy Lock	20lbs	50	28.00

* Requires 2-3/4" by 2-1/2" rectangular cut out.

REPLACEMENT CYLINDERS

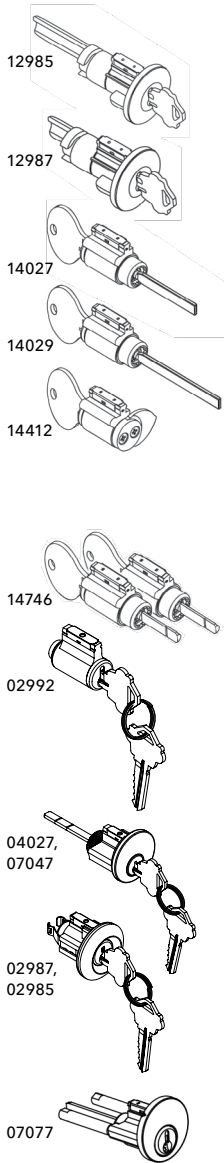

MODEL #	DESCRIPTION	LIST PRICE
MOLTEN BRONZE, ELEGANCE, TRADITIONALE COLLECTIONS		
12292	Molten Bronze, Elegance and Traditionale Collection Lever Keylocks	21.90
12985*	Traditionale Collection Vestibule Keylock	23.30
12987*	Molten Bronze, Elegance, Traditionale Collection Knob Keylocks	21.90
14027*	Molten Bronze, Elegance, Traditionale Entry Handles and Traditionale Single Cylinder Deadbolts (Except 1300 Series &1400 Series Twingard®)	21.90
14029*	Molten Bronze and Elegance Deadbolts, All Molten Bronze and Elegance Entry Handles with 6204, 6404, 6604, 7604 and 7904 Interconnect Interior Kits.	22.50
14412	Traditionale 1300 Series Entry Handles (not available in SC-1 keyway)	23.30
14746*	Molten Bronze, Elegance, and Traditionale Collection Double Cylinder Deadbolts (comes in pairs)	46.00
PREMIERE ESSENTIALS® COLLECTION		
02987	Premiere Essentials Salem Knob Cylinder	19.80
02985	Premiere Essentials Hudson Knob Cylinder	19.80
02992	Premiere Essentials Lever Cylinder	19.80
04027	Premiere Essentials Deadbolt Cylinder	19.80
SC02987	Schlage Premiere Essentials Salem Knob Cylinder	19.80
SC02985	Schlage Premiere Essentials Hudson Knob Cylinder	19.80
SC02992	Schlage Premiere Essentials Lever Cylinder	19.80
SC04027	Schlage Premiere Essentials Deadbolt Cylinder	19.80
KW02987	Kwikset Premiere Essentials Salem Knob Cylinder	19.80
KW02985	Kwikset Premiere Essentials Hudson Knob Cylinder	19.80
KW02992	Kwikset Premiere Essentials lever Cylinder	19.80
KW04027	Kwikset Premiere Essentials Deadbolt Cylinder	19.80
TRANSITIONAL COLLECTION		
07047	Transitional Deadbolt Cylinder	19.80
SC07047	Schlage Transitional Deadbolt Cylinder	19.80
KW07047	Kwikset Transitional Deadbolt Cylinder	19.80
SC07077XN-D	Schlage Cylinder for Addy/Bailey/Brookside/Leighton/Xanthis	19.80
SC07077X2-D	Schlage Cylinder for Addy/Bailey/Brookside/Leighton/Xanthis	19.80
SC07077X1-D	Schlage Cylinder for Addy/Bailey/Brookside/Leighton/Xanthis	19.80
07077X2-D	Schlage Cylinder for Addy/Bailey/Brookside/Leighton/Xanthis	19.80
07077XN-D	Schlage Cylinder for Addy/Bailey/Brookside/Leighton/Xanthis	19.80
07077X1-D	Schlage Cylinder for Addy/Bailey/Brookside/Leighton/Xanthis	19.80

*SC-1 and KW-1 keyways available.

INSTALLATION & MORTISE TOOLS

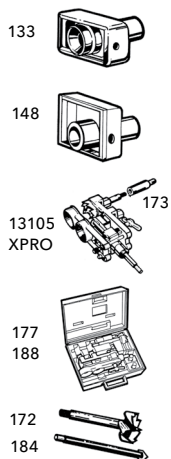

MODEL #	DESCRIPTION	UNIT WEIGHT	LIST PRICE
133	Latch Mortise Maker	9 oz	47.10
134	Strike Locator-Made of hardwood w/steel point for marking jamb to locate strike	2 oz	29.40
148	Strike Mortise Maker	13 oz	58.50
150	Marker & mortise set: 3 piece: Strike Mortise (#148), Latch Mortise (#133), Strike Locator (#134)	1.5 lbs	95.20
13105 XPRO	Boring Jig Assembly Only	7 lb	220.00
172	2 1/8" (54mm) Multi-Spur Machine Bit for use w/Boring Jig #13105 XPRO	12 oz	224.70
173	Adapter for use w/Boring Jig #13105 XPRO	6 oz	117.70
177	Carrying Case for Installation Tools (without tools)	3 lbs	57.80
184	1" (25mm) Spade Machine Bit for use w/Boring Jig #13105 XPRO	1.5 lbs	54.60
188	Installation Kit w/Boring Jig # 13105 XPRO, Marker & Mortise #150, Spacer #130	10 lbs	585.30

KEYING KITS & ACCESSORIES

MODEL #	DESCRIPTION	LIST PRICE
 00101	Kit for re-keying cylinders including master keyed cylinders	175.50
00102	Depth key gauge set	18.80
00105	Plug follower	14.70
12344xBR	Key blanks (50/box)	1.40/each
12345xBR	Cut Keys (master keys, OG keys, etc.)	2.20/each
12344xLOGO	Entry Handle Key Blanks (50/box)	1.50/each
12345xLOGO	Entry Handle Cut Keys (50/box)	2.40/each
12344x(BUI)	Custom Logo Key Blanks (50/box)	2.00/each
12345x(BUI)	Custom Logo Cut Keys (50/box)	2.70/each
SC12344xBR	Key Blanks - Schlage Keyway (50/box)	1.60/each
13175	Bottom pin segments (100/bag) : #0-10/64", #1-11/64", #2-12/64", #3-13/64", #4-14/64", #5-15/64", #6-16/64", #7-17/64", #8-18/64", #9-19/64"	13.00
13176	Driver pin segments (100/bag) : #8-8/64", #11-11/64", #12-12/64", #14-14/64"	13.00
13177	Master pin segments (100/bag) : #2-2/64", #3-3/64", #4-4/64", #5-5/64", #6-6/64", #7-7/64", #8-8/64", #9-9/64"	13.00
14560XST	Owner Guard Ball (100/bag)	13.00
13716	Brass bushing	26.80
14111	Wrench - cylinder plug retaining cap	6.10
15201	Key gauge (to determine key cut depth)	7.00
KW105	200 Series Plug follower	13.30
12344xBR-PE	Premiere Essentials / Transitional key blank	1.40
SC12344xBR-PE	Schlage Premiere Essentials / Transitional key blank	1.40
KW12344xBR-PE	Kwikset Premiere Essentials / Transitional key blank	1.40
14133xPRO	200 Series cylinder removal tool (picklefork)	3.00

EXTRA THICK & THIN DOOR KITS

MODEL #	DESCRIPTION	LIST PRICE
THICK DOOR KITS		
L/K0200x_*	Up to 2-1/4" Extra Thick Door Pack - Traditionale Collections Entry Handles, 371 Deadbolts, & Passages	16.10
00210x_*	Up to 2-1/4" Extra Thick Door Pack - Fits 671 Deadbolts and 1500 Series Interconnected	16.10
L/K0215x_*	Up to 2-1/4" Extra Thick Door Pack - Fits Traditionale Collections Keylocks & Privacies	16.10
00900x_*	Up to 2-1/4" Extra Thick Door Pack - Fits Molten Bronze Collection 7925/7625 only Entry Handles	16.10
L/K0904	Up to 2-1/4" Extra Thick Door Pack - Fits Molten Bronze & Elegance Collection Passages	16.10
L/K0905	Up to 2-1/4" Extra Thick Door Pack - Fits Molten Bronze & Elegance Collection Entry Handles (6611/6641/6651/6681/6691/7631/7680/7931/7980)	16.10
00910x_*	Up to 2-1/4" Extra Thick Door Pack - Fits Molten Bronze and Elegance Collection Deadbolts	16.10
L/K0915x_*	Up to 2-1/4" Extra Thick Door Pack - Fits Molten Bronze and Elegance Collection Keylocks & Privacies	16.10
L/K0917	Up to 2-1/4" Extra Thick Door Pack - Fits 7641/7941/6631/6671	16.10
Note: No thick door kits available for any double cylinder deadbolts or double cylinder entry handles.		
THIN DOOR KITS		
00147x_*	1 3/8" Thin Door Kit - Traditionale Collection (2115/2175/351)	22.70
00149x	1 3/8" Thin Door Kit - Molten Bronze and Elegance Collection (6641/6651/6681/6691/7631/7680/7931/7980)	22.70
00145x_*	1 3/8" Thin Door Kit - Molten Bronze Collection (7925/7625)	22.70
00143x_*	1 3/8" Thin Door Kit - Molten Bronze Collection (7641/7651)	22.70

*When ordering, please specify 1) finish and 2) knob (K) or lever (L) style.

STRIKES

MODEL #	DESCRIPTION	CORNER	DIMENSIONS	LIST PRICE
---------	-------------	--------	------------	------------

**MOLTEN BRONZE, ELEGANCE, TRADITIONALE COLLECTIONS
KNOBS & LEVERS, INCLUDING LIP**

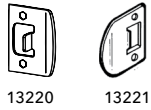

13220	Full Lip, Adjustable Tab	Square	2-1/4" x 1-3/4"	3.90
13221	Full Lip, Adjustable Tab	Radius	2-1/4" x 1-3/4"	3.90

*Please specify finish when ordering.

**MOLTEN BRONZE, ELEGANCE, TRADITIONALE COLLECTIONS
DEADBOLTS**

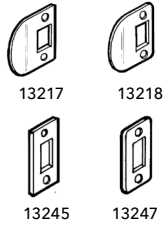

13217	Full Lip, Deadbolt	Square	2-1/4" x 1-3/4"	3.90
13218	Full Lip, Deadbolt	Radius	2-1/4" x 1-3/4"	3.90
13245	No Lip, Deadbolt	Square	2-1/4" x 1"	3.90
13247	No Lip, Deadbolt	Radius	2-1/4" x 1"	3.90

*Please specify finish when ordering.

**PREMIERE ESSENTIALS® / TRANSITIONAL COLLECTIONS
DEADBOLTS, KNOBS & LEVERS, INCLUDING LIP**

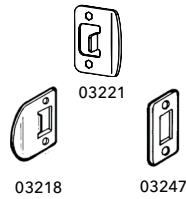

03221	Full Lip, Adjustable Tab	Radius	2-1/4" x 1-3/4"	3.90
03218	Full Lip, Deadbolt	Radius	2-1/4" x 1-3/4"	3.90
03247	No Lip, Deadbolt	Radius	2-1/4" x 1"	3.90

*Please specify finish when ordering.

SPECIAL APPLICATION

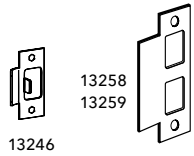

13258	ASA "T" Type, Combination Right Hand	Square	4-7/8" x 1-1/4" + Lip	15.30
13259	ASA "T" Type, Combination Left Hand	Square	4-7/8" x 1-1/4" + Lip	15.30
13246	No Lip, Deadbolt	Square	2-1/4" x 1-1/8"	15.30

*Please specify finish when ordering.

LATCH FACEPLATES

MODEL #	DESCRIPTION	LIST PRICE
DEADLATCH		
12282	Mortise Faceplate - Radius (Traditionale, Elegance & Molten Bronze Collection)	2.00
12281	Mortise Faceplate - Square (Traditionale, Elegance & Molten Bronze Collection)	2.00
14270	Mortise Faceplate - Square (1300 Series)	2.00
14271	Mortise Faceplate - Radius (1300 Series)	2.00
SPRINGLATCH		
12227	Mortise Faceplate - Square (Traditionale, Elegance & Molten Bronze Collection)	2.00
12228	Mortise Faceplate - Radius (Traditionale, Elegance & Molten Bronze Collection)	2.00
14279	Mortise Faceplate - Square (1400/1500 Series)	2.00
14280	Mortise Faceplate - Radius (1400/1500 Series)	2.00
DEADBOLT		
15701	Mortise Faceplate - Radius (Traditionale, Elegance & Molten Bronze Collection)	2.00
15686	Mortise Faceplate - Square (Traditionale, Elegance & Molten Bronze Collection)	2.00

*Please specify finish when ordering.

LATCHES (SL - INCLUDES BOTH RADIUS AND SQUARE FACEPLATES)

MODEL #	LEVER STRENGTH MODEL #	STRAIGHT LEVER STRENGTH MODEL #	BACKSET ADJ.	FACEPLATE			LIST PRICE
				WIDTH	CORNER	TYPE	
 <p>MOLTEN BRONZE, ELEGANCE, & TRADITIONALE COLLECTIONS: PASSAGE/PRIVACY KNOBS, LEVERS, & ENTRY HANDLES - SPRINGLATCH</p>							
12720-SL	32720-SL	52720-SL	2-3/8" to 2-3/4"	1"	Radius/Square	Removable	9.10
12725-DI	32725-DI	52725-DI	2-3/8" to 2-3/4"	None	Non-Mortise (Drive-in)		9.10
 <p>MOLTEN BRONZE, ELEGANCE, & TRADITIONALE COLLECTIONS: KEYLOCK, KNOBS & LEVERS - DEADLATCH</p>							
12721-SL	32721-SL	52721-SL	2-3/8" to 2-3/4"	1"	Radius/Square	Removable	16.50
12728-DI	32728-DI	52728-DI	2-3/8" to 2-3/4"	None	Non-Mortise (Drive-in)		16.50
 <p>MOLTEN BRONZE, ELEGANCE, & TRADITIONALE COLLECTIONS: ENTRY HANDLES & DEADBOLTS - DEADBOLT LATCH</p>							
12818-SL	-	-	2-3/8" to 2-3/4"	1"	Radius/ Square	Removable	22.70
12820-DI	-	-	2-3/8" to 2-3/4"	None	Non-Mortise (Drive-in)		22.70
 <p>PREMIERE ESSENTIALS® COLLECTION: PASSAGE/PRIVACY KNOBS & LEVERS - SPRINGLATCH</p>							
02720X	N/A	N/A	2-3/8" to 2-3/4"	1"	Radius	Fixed	8.80
02725X	N/A	N/A	2-3/8" to 2-3/4"	None	Non-Mortise		8.80
ENTRY HANDLE - SPRINGLATCH							
02738X	N/A	N/A	2-3/8"	1"	Radius	Fixed	8.80
02734X	N/A	N/A	2-3/4"	1"	Radius	Fixed	8.80
KEYLOCK KNOBS & LEVERS - DEADLATCH							
02721X	N/A	N/A	2-3/8" to 2-3/4"	1"	Radius	Fixed	8.80
02728X	N/A	N/A	2-3/8" to 2-3/4"	None	Non-Mortise		8.80
 <p>TRANSITIONAL COLLECTION: PASSAGE/PRIVACY KNOBS & LEVERS - SPRINGLATCH</p>							
01720X	N/A	N/A	2-3/8" to 2-3/4"	1"	Radius	Fixed	8.80
01725X	N/A	N/A	2-3/8" to 2-3/4"	None	Non-Mortise		8.80
ENTRY HANDLE - SPRINGLATCH							
01730XSL	N/A	N/A	2-3/8" to 2-3/4"	1"	Radius	Fixed	8.80
ENTRY HANDLE - DEADBOLT LATCH							
12819XSL	N/A	N/A	2-3/8" to 2-3/4"	1"	Radius	Fixed	8.80
 <p>PREMIERE ESSENTIALS® & TRANSITIONAL COLLECTIONS: DEADBOLTS - DEADBOLT LATCH</p>							
02817X	N/A	N/A	2-3/8" to 2-3/4"	1"	Radius	Fixed	8.80
02820X	N/A	N/A	2-3/8" to 2-3/4"	None	Non-Mortise		8.80
 <p>MULTI-FAMILY COLLECTION: PASSAGE/PRIVACY KNOBS & LEVERS - SPRINGLATCH (20 MINUTE U.L.)</p>							
U1730XSL	N/A	N/A	2-3/8" to 2-3/4"	1"	Radius/Square	Removable	11.40
DEADBOLTS-DEADBOLT LATCH (20 MINUTE U.L.)							
U12819XSL	N/A	N/A	2-3/8" to 2-3/4"	1"	Radius/Square	Removable	22.70

^Please specify finish when ordering.

LATCHES (SL - INCLUDES BOTH RADIUS AND SQUARE FACEPLATES)

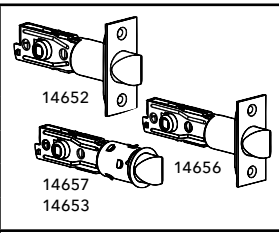
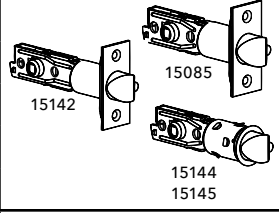
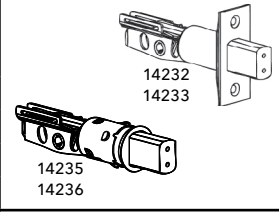
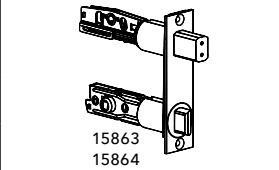
MODEL #	LEVER STRENGTH MODEL #	STRAIGHT LEVER STRENGTH MODEL #	BACKSET ADJ.	FACEPLATE			LIST PRICE
				WIDTH	CORNER	TYPE	
 <p>INTERCONNECT (UNIGARD® 1500 SERIES & 1441, 1411) - SPRINGLATCH</p>							
14652-SL	-	-	2-3/8"	1"	Radius/Square	Removable	15.90
14656-SL	-	-	2-3/4"	1"	Radius/Square	Removable	15.90
14653-DI	-	-	2-3/8"	None	Non-Mortise (Drive-in)		15.90
14657-DI	-	-	2-3/4"	None	Non-Mortise (Drive-in)		15.90
 <p>TRADITIONALE (1343, 1313) - DEADLATCH</p>							
15085-SL	-	-	2-3/8"	1"	Radius/Square	Removable	22.70
15142-SL	-	-	2-3/4"	1"	Radius/Square	Removable	22.70
15144-DL	-	-	2-3/8"	1"	Non-Mortise (Drive-in)		22.70
15145-DL	-	-	2-3/4"	1"	Non-Mortise (Drive-in)		22.70
 <p>INTERCONNECT (1400 & 1500 SERIES) & TRADITIONALE (1300 SERIES) - DEADBOLTS</p>							
14232-SL	-	-	2-3/8"	1"	Radius/Square	Removable	24.00
14233-SL	-	-	2-3/4"	1"	Radius/Square	Removable	24.00
14235-DI	-	-	2-3/8"	None	Non-Mortise (Drive-in)		24.00
14236-DI	-	-	2-3/4"	None	Non-Mortise (Drive-in)		24.00
 <p>NON-U.L. COMBINED - SPRINGLATCH & DEADBOLT</p>							
15863-38	-	-	2-3/8"	1-1/8"	Square	Fixed	56.00
15864-34	-	-	2-3/4"	1-1/8"	Square	Fixed	56.00

^Please specify finish when ordering.

LITERATURE

MODEL #	DESCRIPTION	LIST PRICE
08858-2	Weslock Price Book (Available Only as PDF on www.weslock.com)	-
08859-2	Weslock Product Catalog	-
08865-2	Weslock Service Parts Book (Available Only as PDF on www.weslock.com)	-
08900-2	Weslock Binder (No Contents)	-
09230-2	Weslock Full Product Line Rack Brochure	-
08808-4	Warranty Card (Available as PDF on www.weslock.com)	-

WESLOCK® DISPLAY MOUNTS* (CREDIT APPLICATION REQUIRED)

MODEL #	DESCRIPTION	LIST PRICE
9011	Lucite Demonstrator for any Knob or Lever	15.00
9103	Showroom Display	5000.00
9206	Display Mount for Interconnected & Unigard Entry Handles (1400 series, 1501/1502)	50.00
9215	Display Mount for Interconnected ASA Entry Handles (1510/1520)	50.00
9207	Display Mount for 1300 Series Two Point Locking	50.00
9209	Display Mount for Impresa Dummy Knobs	50.00
9702	Display Mount for Premiere Essentials, Traditionale, Elegance & Molten Bronze Entry Handles	50.00
9208-1	Display Mount for any 4 Premiere Essentials Collection Knob, Lever or Deadbolt Combination	50.00
9208-6	Display Mount for any 4 Traditionale Collection Knob, Lever or Deadbolt Combination	50.00
9208-7	Display Mount for any 4 Elegance Collection Knob, Lever or Deadbolt Combination (Excluding Woodward)	50.00
9208-M	Display Mount for any 4 Molten Bronze Collection Knob, Lever or Deadbolt Combination	50.00
9238	Display Mount for any 4 Elegance Woodward Collection Knob, Lever or Deadbolt Combination	50.00
9250XM	Display Combo Mount for any Entry Handles, Knobs, Levers or Deadbolts	80.00

*Display mounts are furnished at "No Charge" when ordered with mounted hardware. Mounted hardware is billed at the retail list price. There is a charge when ordering empty mounts.

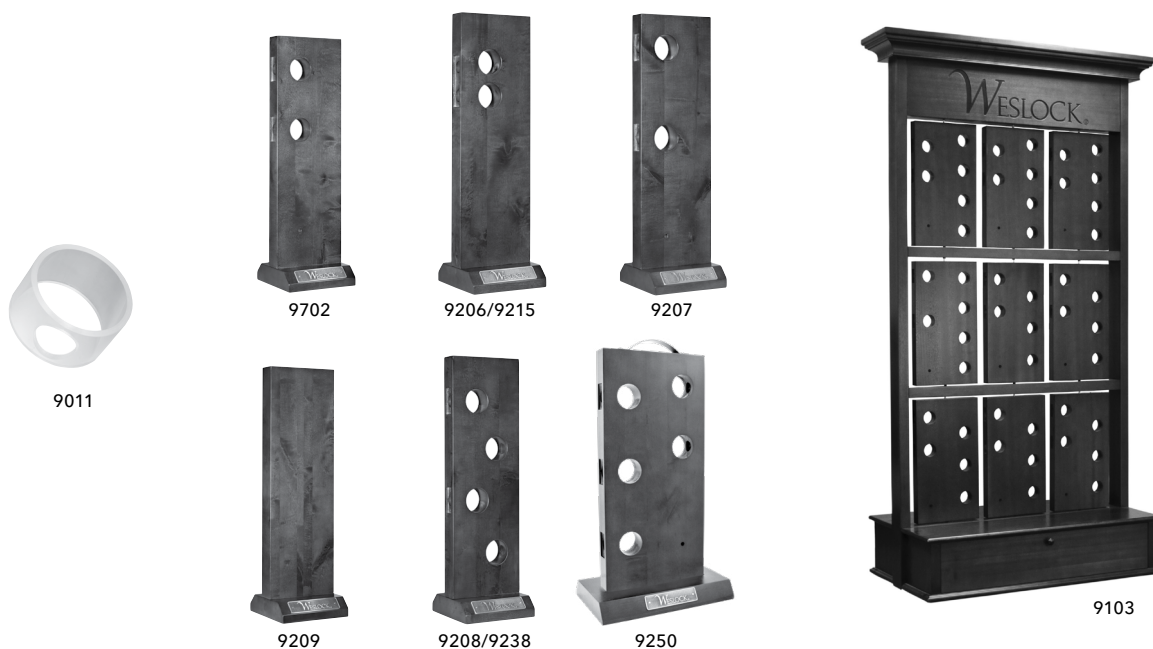

WESLOCK® DISPLAY BOARDS* (CREDIT APPLICATION REQUIRED)

MODEL #	DESCRIPTION	LIST PRICE
9212-2A	Premiere Essentials Collection Multi-Finish Display Board	50.00
9212-6A	Traditionale Collection Multi-Finish Display Board	50.00
9212-7A	Elegance Collection Multi-Finish Display Board	50.00
9212-MA	Molten Bronze Collection Multi-Finish Display Board	50.00
9212-BA	Bath Hardware Collection Multi-Finish Display Board	50.00
9212-TA	Transitional Collection Multi-Finish Display Board	50.00
9212-XX	Custom Display Board	50.00

*Display boards are furnished at "No Charge" when ordered with mounted hardware. Mounted hardware is billed at the retail list price. There is a charge when ordering empty mounts.

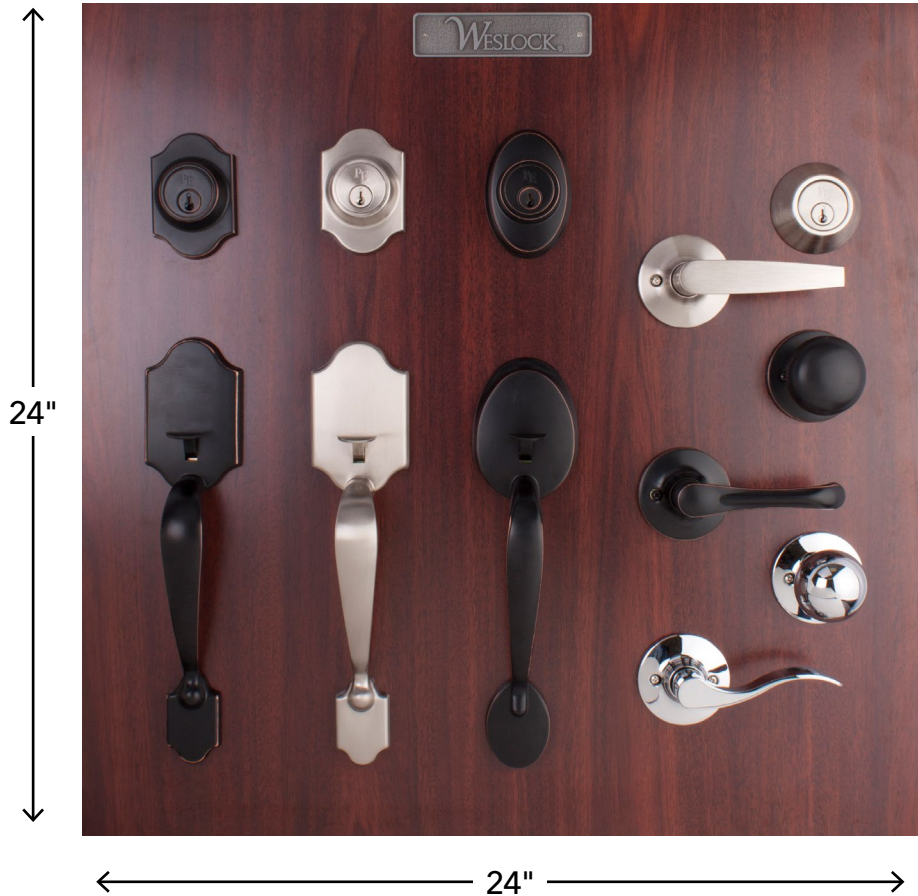

WESLOCK®

Security | Safety | Style | Since 1932



For more information call us at:

1-800-575-2658
(BOLT)

www.WESLOCK.com

COPYRIGHT WESLOCK®, 2021
ALL RIGHTS RESERVED